

SUMMARY REPORT  
556 DAHLIA DRIVE (FORMERLY 637 DAHLIA DRIVE)  
LAUREL BAY MILITARY HOUSING AREA  
MARINE CORPS AIR STATION BEAUFORT  
BEAUFORT, SC

Revision: 0  
Prepared for:

Department of the Navy  
Naval Facilities Engineering Command, Mid-Atlantic  
9324 Virginia Avenue  
Norfolk, Virginia 23511-3095

and



Naval Facilities Engineering Command Atlantic  
9324 Virginia Avenue  
Norfolk, Virginia 23511-3095

JUNE 2021

SUMMARY REPORT  
556 DAHLIA DRIVE (FORMERLY 637 DAHLIA DRIVE)  
LAUREL BAY MILITARY HOUSING AREA  
MARINE CORPS AIR STATION BEAUFORT  
BEAUFORT, SC

Revision: 0  
Prepared for:

Department of the Navy  
Naval Facilities Engineering Command, Mid- Atlantic  
9324 Virginia Avenue  
Norfolk, Virginia 23511-3095

and



Naval Facilities Engineering Command Atlantic

9324 Virginia Avenue  
Norfolk, Virginia 23511-3095

Prepared by:



CDM - AECOM Multimedia Joint Venture  
10560 Arrowhead Drive, Suite 500  
Fairfax, Virginia 22030

Contract Number: N62470-14-D-9016  
CTO WE52  
JUNE 2021

---

## Table of Contents

1.0	INTRODUCTION.....	1
1.1	BACKGROUND INFORMATION.....	1
1.2	UST REMOVAL AND ASSESSMENT PROCESS.....	2
2.0	SAMPLING ACTIVITIES AND RESULTS.....	3
2.1	UST REMOVAL AND SOIL SAMPLING .....	3
2.2	SOIL ANALYTICAL RESULTS.....	4
3.0	PROPERTY STATUS .....	4
4.0	REFERENCES.....	4

## Table

Table 1	Laboratory Analytical Results - Soil
---------	--------------------------------------

## Appendices

Appendix A	Multi-Media Selection Process for LBMH
Appendix B	UST Assessment Report
Appendix C	Regulatory Correspondence

---

## List of Acronyms

bgs	below ground surface
BTEX	benzene, toluene, ethylbenzene, and xylenes
CTO	Contract Task Order
COPC	constituents of potential concern
IDIQ	Indefinite Delivery, Indefinite Quantity
IGWA	Initial Groundwater Assessment
JV	Joint Venture
LBMH	Laurel Bay Military Housing
MCAS	Marine Corps Air Station
NAVFAC Mid-Lant	Naval Facilities Engineering Command Mid-Atlantic
NFA	No Further Action
PAH	polynuclear aromatic hydrocarbon
QAPP	Quality Assurance Program Plan
RBSL	risk-based screening level
SCDHEC	South Carolina Department of Health and Environmental Control
Site	LBMH area at MCAS Beaufort, South Carolina
UST	underground storage tank
VISL	vapor intrusion screening level

## 1.0 INTRODUCTION

The CDM - AECOM Multimedia Joint Venture (JV) was contracted by the Naval Facilities Engineering Command, Mid-Atlantic (NAVFAC Mid-Lant) to provide reporting services for the heating oil underground storage tanks (USTs) located in Laurel Bay Military Housing (LBMH) area at the Marine Corps Air Station (MCAS) Beaufort, South Carolina (Site). This work has been awarded under Contract Task Order (CTO) WE52 of the Indefinite Delivery, Indefinite Quantity (IDIQ) Multimedia Environmental Compliance Contract (Contract No. N62470-14-D-9016).

As of January 2014, the LBMH addresses were re-numbered to comply with the E-911 emergency response addressing system; however, in order to remain consistent with historical sampling and reporting for LBMH area, the residences will continue to be referenced with their original address numbers in sample nomenclature and reporting documents.

This report summarizes the results the environmental investigation activities associated with the storage of home heating oil and the potential release of petroleum constituents at the referenced property. Based on the results of the investigation, a No Further Action (NFA) determination has been made by the South Carolina Department of Health and Environmental Control (SCDHEC) for 556 Dahlia Drive (Formerly 637 Dahlia Drive). This NFA determination indicates that there are no unacceptable risks to human health or the environment for the petroleum constituents associated with the home heating oil USTs. The following information is included in this report:

- Background information;
- Sampling activities and results; and
- A determination of the property status.

### 1.1 Background Information

The LBMH area is located approximately 3.5 miles west of MCAS Beaufort. The area is approximately 970 acres in size and serves as an enlisted and officer family housing area. The area is configured with single family and duplex residential structures, and includes recreation, open space, and community facilities. The community includes approximately 1,300 housing units, including legacy Capehart style homes and newer duplex style homes. The housing area

is bordered on the west by salt marshes and the Broad River, and to the north, east and south by uplands. Forested areas lie along the northern and northeastern borders.

Capehart style homes within the LBMH area were formerly heated using heating oil stored in USTs at each residence. There were 1,100 Capehart style housing units in the LBMH area. The newer duplex homes within the LBMH area never utilized heating oil tanks. Heating oil has not been used at Laurel Bay since the mid-1980s. As was the accepted practice at the time, USTs were drained, filled with dirt, capped, and left in place when they were removed from service. Residential USTs are not regulated in the State of South Carolina (i.e., there are no federal or state laws governing installation, management, or removal).

In 2007, MCAS Beaufort began a voluntary program to remove the unregulated, residential USTs and conduct sampling activities to determine if, and to what extent, petroleum constituents may have impacted the surrounding environment. MCAS Beaufort coordinated with SCDHEC to develop removal procedures that were consistent with procedural requirements for regulated USTs. All tank removal activities and follow-on actions are conducted in coordination with SCDHEC. To date, all known USTs have been removed from all residential properties within the LBMH area.

## 1.2 UST Removal and Assessment Process

During the UST removal process, a soil sample was collected from beneath the UST excavations (approximately 4 to 6 feet [ft] below ground surface [bgs]) and analyzed for a predetermined list of constituents of potential concern (COPCs) associated with the petroleum compounds found in home heating oil. These COPCs, derived from the *Quality Assurance Program Plan (QAPP) for the Underground Storage Tank Management Division, Revision 3.1* (SCDHEC, 2016) and the *Underground Storage Tank Assessment Instructions for Permanent Closure and Change-In-Service*, (SCDHEC, 2018), are as follows:

- benzene, toluene, ethylbenzene, and xylenes (BTEX),
- naphthalene, and
- five select polynuclear aromatic hydrocarbon (PAHs): benzo(a)anthracene, benzo(b)fluoranthene, benzo(k)fluoranthene, chrysene and dibenz(a,h)anthracene.

Soil sample results were submitted by MCAS Beaufort to SCDHEC utilizing SCDHEC's UST Assessment Report form. In accordance with SCDHEC's *QAPP for the UST Management*

*Division* (SCDHEC, 2016), the soil screening levels consists of SCDHEC risk-based screening levels (RBSLs). It should be noted that the RBSLs for select PAHs were revised in Revision 2.0 of the QAPP (SCDHEC, 2013) and were revised again in Revision 3.0 (SCDHEC, 2015). The screening levels used for evaluation at each site were those levels that were in effect at the time of reporting and review by SCDHEC.

The results of the soil sampling at each former UST location were used to determine if a potential for groundwater contamination exists (i.e., soil results greater than RBSLs) and subsequently to select properties for follow-up initial groundwater assessment (IGWA) sampling. The results of the IGWA sampling (if necessary) are used to determine the presence or absence of the aforementioned COPCs in groundwater and identify whether former UST locations will require additional delineation of COPCs in groundwater. In order to delineate the extent of impact to groundwater, permanent wells are installed and a sampling program is established for those former UST locations where IGWA sampling has indicated the presence of COPCs in excess of the SCDHEC RBSLs for groundwater. Groundwater analytical results are also compared to the site specific groundwater vapor intrusion screening levels (VISLs) to evaluate the potential for vapor intrusion and the necessity for an investigation associated with this media. A multi-media investigation selection process tree, applicable to the LBMH UST investigations, is presented as Appendix A.

## 2.0 SAMPLING ACTIVITIES AND RESULTS

The following section presents the sampling activities and associated results for 556 Dahlia Drive (Formerly 637 Dahlia Drive). Details regarding the soil investigation at this site are provided in the *SCDHEC UST Assessment Report – 637 Dahlia Drive* (MCAS Beaufort, 2013). The UST Assessment Report is provided in Appendix B.

### 2.1 UST Removal and Soil Sampling

On May 21, 2013, two 280 gallon heating oil USTs were removed from the concrete porch area at 556 Dahlia Drive (Formerly 637 Dahlia Drive). The former UST locations are indicated on Figures 2 and 3 of the UST Assessment Report (Appendix B). The USTs were removed and properly disposed of (i.e., shipped offsite for recycling or transported to a landfill). There was no visual evidence (i.e., staining or sheen) of petroleum impact at the time of the UST removals. According to the UST Assessment Report (Appendix B), the depths to the bases of the USTs were 4'2" bgs (Tank 1) and 6'0" bgs (Tank 2) and a single soil sample was collected

for each from that depth. The samples were collected from the fill port side of the former USTs to represent a worst case scenario.

Following UST removals, a soil sample was collected from the base of each excavation and shipped to an offsite laboratory for analysis of the petroleum COPCs. Sampling was performed in accordance with applicable South Carolina regulation R.61-92, Part 280 (SCDHEC, 2017) and assessment guidelines.

## 2.2 Soil Analytical Results

A summary of the laboratory analytical results and SCDHEC RBSLs is presented in Table 1. A copy of the laboratory analytical data report is included in the UST Assessment Report presented in Appendix B. The laboratory analytical data report includes the soil results for the additional PAHs that were analyzed, but do not have associated RBSLs.

The soil sample results were submitted by MCAS Beaufort to SCDHEC utilizing SCDHEC's UST Assessment Report form (Appendix B). The results of the soil sampling at the former UST locations (Tanks 1 and 2) were used by MCAS Beaufort, in consultation with SCDHEC, to determine a path forward (i.e., additional sampling or NFA) for the property. The soil results collected from the former UST locations (Tanks 1 and 2) at 556 Dahlia Drive (Formerly 637 Dahlia Drive) were less than the SCDHEC RBSLs, which indicated the subsurface was not impacted by COPCs associated with the former USTs at concentrations that presented a potential risk to human health and the environment.

## 3.0 PROPERTY STATUS

Based on the analytical results for soil, SCDHEC made the determination that NFA was required for 556 Dahlia Drive (Formerly 637 Dahlia Drive). This NFA determination was obtained in a letter dated July 1, 2015. SCDHEC's NFA letter is provided in Appendix C.

## 4.0 REFERENCES

Marine Corps Air Station Beaufort, 2013. *South Carolina Department of Health and Environmental Control (SCDHEC) Underground Storage Tank Assessment Report – 637 Dahlia Drive, Laurel Bay Military Housing Area*, October 2013.



South Carolina Department of Health and Environmental Control Bureau of Land and Waste Management, 2013. *Quality Assurance Program Plan for the Underground Storage Tank Management Division, Revision 2.0*, April 2013.

South Carolina Department of Health and Environmental Control Bureau of Land and Waste Management, 2015. *Quality Assurance Program Plan for the Underground Storage Tank Management Division, Revision 3.0*, May 2015.

South Carolina Department of Health and Environmental Control Bureau of Land and Waste Management, 2016. *Quality Assurance Program Plan for the Underground Storage Tank Management Division, Revision 3.1*, February 2016.

South Carolina Department of Health and Environmental Control Bureau of Land and Waste Management, 2017. *R.61-92, Part 280, Underground Storage Tank Control Regulations*, March 2017.

South Carolina Department of Health and Environmental Control Bureau of Land and Waste Management, 2018. *Underground Storage Tank Assessment Instructions for Permanent Closure and Change-In-Service*, March 2018.

## Table

**Table 1**  
**Laboratory Analytical Results - Soil**  
**556 Dahlia Drive (Formerly 637 Dahlia Drive)**  
**Laurel Bay Military Housing Area**  
**Marine Corps Air Station Beaufort**  
**Beaufort, South Carolina**

Constituent	SCDHEC RBSLs <sup>(1)</sup>	Results Samples Collected 05/21/13	
		637 Dahlia -1	637 Dahlia -2
Volatile Organic Compounds Analyzed by EPA Method 8260B (mg/kg)			
Benzene	0.003	ND	ND
Ethylbenzene	1.15	ND	ND
Naphthalene	0.036	ND	ND
Toluene	0.627	ND	ND
Xylenes, Total	13.01	ND	ND
Semivolatile Organic Compounds Analyzed by EPA Method 8270D (mg/kg)			
Benzo(a)anthracene	0.66	ND	ND
Benzo(b)fluoranthene	0.66	ND	ND
Benzo(k)fluoranthene	0.66	ND	ND
Chrysene	0.66	ND	ND
Dibenz(a,h)anthracene	0.66	ND	ND

**Notes:**

<sup>(1)</sup> South Carolina Risk-Based Screening Levels from the Quality Assurance Program Plan for the Underground Storage Tank Management Division, Revision 3.0 and 3.1 (SCDHEC, May 2015 and SCDHEC, February 2016) and the Underground Storage Tank Assessment Guidelines (SCDHEC, February 2006).

Bold font indicates the analyte was detected.

Bold font and shading indicates the concentration exceeds the SCDHEC RBSL.

EPA - United States Environmental Protection Agency

mg/kg - milligram per kilogram

ND - not detected at the reporting limit (or method detection limit if shown on the laboratory report). The laboratory report is provided in Appendix B.

RBSL - Risk-Based Screening Level

SCDHEC - South Carolina Department Of Health and Environmental Control

**Appendix A**  
**Multi-Media Selection Process for LBMH**



Appendix A - Multi-Media Selection Process for LBMH

**Appendix B**  
**UST Assessment Report**

South Carolina Department of Health and Environmental Control (SCDHEC)  
**Underground Storage Tank (UST) Assessment Report**

Date Received
State Use Only

**Submit Completed Form To:**  
**UST Program**  
**SCDHEC**  
**2600 Bull Street**  
**Columbia, South Carolina 29201**  
**Telephone (803) 896-7957**

RECEIVED

OCT 23 2014

**SC DHEC - Bureau of  
Land & Waste Management**

**I. OWNERSHIP OF UST (S)**

MCAS Beaufort, Commanding Officer Attn: NREAO (Craig Ehde)

Owner Name (Corporation, Individual, Public Agency, Other)

P.O. Box 55001

Mailing Address

Beaufort,	South Carolina	29904-5001
City	State	Zip Code

843	228-7317	Craig Ehde
Area Code	Telephone Number	Contact Person

**II. SITE IDENTIFICATION AND LOCATION**

Permit I.D. #

Laurel Bay Military Housing Area, Marine Corps Air Station, Beaufort, SC

Facility Name or Company Site Identifier

637 Dahlia Drive, Laurel Bay Military Housing Area

Street Address or State Road (as applicable)

Beaufort,	Beaufort
City	County

### III. INSURANCE INFORMATION

#### Insurance Statement

The petroleum release reported to DHEC on \_\_\_\_\_ at Permit ID Number \_\_\_\_\_ may qualify to receive state monies to pay for appropriate site rehabilitation activities. Before participation is allowed in the State Clean-up fund, written confirmation of the existence or non-existence of an environmental insurance policy is required. **This section must be completed.**

Is there now, or has there ever been an insurance policy or other financial mechanism that covers this UST release? **YES**\_\_\_\_ **NO**\_\_\_\_ (check one)

If you answered **YES** to the above question, please complete the following information:

My policy provider is: \_\_\_\_\_

The policy deductible is: \_\_\_\_\_

The policy limit is: \_\_\_\_\_

If you have this type of insurance, please include a copy of the policy with this report.

### IV. REQUEST FOR SUPERB FUNDING

I **DO** / **DO NOT** wish to participate in the SUPERB Program. (Circle one.)

### V. CERTIFICATION (To be signed by the UST owner)

**I certify that I have personally examined and am familiar with the information submitted in this and all attached documents; and that based on my inquiry of those individuals responsible for obtaining this information, I believe that the submitted information is true, accurate, and complete.**

Name (Type or print.) \_\_\_\_\_

Signature \_\_\_\_\_

#### To be completed by Notary Public:

Sworn before me this \_\_\_\_\_ day of \_\_\_\_\_, 20\_\_\_\_

\_\_\_\_\_  
(Name)

Notary Public for the state of \_\_\_\_\_  
*Please affix State seal if you are commissioned outside South Carolina*



## VI. UST INFORMATION

- A. Product...(ex. Gas, Kerosene).....
- B. Capacity...(ex. 1k, 2k).....
- C. Age.....
- D. Construction Material...(ex. Steel, FRP).....
- E. Month/Year of Last Use.....
- F. Depth (ft.) To Base of Tank.....
- G. Spill Prevention Equipment Y/N.....
- H. Overfill Prevention Equipment Y/N.....
- I. Method of Closure Removed/Filled.....
- J. Date Tanks Removed/Filled.....
- K. Visible Corrosion or Pitting Y/N.....
- L. Visible Holes Y/N.....

637Dahlia-1	637Dahlia-2	
Heating oil	Heating oil	
280 gal	280 gal	
Late 1950s	Late 1950s	
Steel	Steel	
Mid 80s	Mid 80s	
4'2"	6'	
No	No	
No	No	
Removed	Removed	
5/21/2013	5/21/2013	
Yes	Yes	
Yes	Yes	

- M. Method of disposal for any USTs removed from the ground (attach disposal manifests)  
USTs 637Dahlia-1 and 637Dahlia-2 were removed from the ground  
and disposed in a Subtitle "D" landfill. See Attachment "A".
- N. Method of disposal for any liquid petroleum, sludges, or wastewaters removed from the USTs (attach disposal manifests)  
Both tanks had been previously filled with sand by others.
- O. If any corrosion, pitting, or holes were observed, describe the location and extent for each UST  
Corrosion, pitting and holes were found in both tanks.

## VII. PIPING INFORMATION

- A. Construction Material..(ex. Steel, FRP).....
- B. Distance from UST to Dispenser.....
- C. Number of Dispensers.....
- D. Type of System Pressure or Suction.....
- E. Was Piping Removed from the Ground? Y/N
- F. Visible Corrosion or Pitting Y/N.....
- G. Visible Holes Y/N.....
- H. Age.....
- I. If any corrosion, pitting, or holes were observed, describe the location and extent for each piping run.

637Dahlia-1	637Dahlia-2	
Steel & Copper	Steel & Copper	
N/A	N/A	
N/A	N/A	
Suction	Suction	
No	No	
Yes	Yes	
No	No	
Late 1950s	Late 1950s	

Steel vent piping for both tanks were corroded and pitted. All  
copper supply and return piping were sound.

## VIII. BRIEF SITE DESCRIPTION AND HISTORY

The USTs at the residences are constructed of single wall steel  
and formerly contained fuel oil for heating. These USTs were  
installed in the late 1950s and last used in the mid 1980s.

## IX. SITE CONDITIONS

	Yes	No	Unk
<p>A. Were any petroleum-stained or contaminated soils found in the UST excavation, soil borings, trenches, or monitoring wells?</p> <p>If yes, indicate depth and location on the site map.</p>		X	
<p>B. Were any petroleum odors detected in the excavation, soil borings, trenches, or monitoring wells?</p> <p>If yes, indicate location on site map and describe the odor (strong, mild, etc.)</p>		X	
<p>C. Was water present in the UST excavation, soil borings, or trenches?</p> <p>If yes, how far below land surface (indicate location and depth)?</p>		X	
<p>D. Did contaminated soils remain stockpiled on site after closure?</p> <p>If yes, indicate the stockpile location on the site map.</p> <p>Name of DHEC representative authorizing soil removal:</p>		X	
<p>E. Was a petroleum sheen or free product detected on any excavation or boring waters?</p> <p>If yes, indicate location and thickness.</p>		X	

## X. SAMPLE INFORMATION

A. SCDHEC Lab Certification Number 84009

B.

Sample #	Location	Sample Type (Soil/Water)	Soil Type (Sand/Clay)	Depth*	Date/Time of Collection	Collected by	OVA #
637 Dahlia-1	Excav at fill end	Soil	Sandy	4'2"	5/21/13 1345 hrs	P. Shaw	
637 Dahlia-2	Excav at fill end	Soil	Sandy	6'	5/21/13 1515 hrs	P. Shaw	
8							
9							
10							
11							
12							
13							
14							
15							
16							
17							
18							
19							
20							

\* = Depth Below the Surrounding Land Surface

## XI. SAMPLING METHODOLOGY

Provide a detailed description of the methods used to collect and store the samples. Also include the preservative used for each sample. Please use the space provided below.

Sampling was performed in accordance with SC DHEC R.61-92 Part 280 and SC DHEC Assessment Guidelines. Sample containers were prepared by the testing laboratory. The grab method was utilized to fill the sample containers leaving as little head space as possible and immediately capped. Soil samples were extracted from area below tank. The samples were marked, logged, and immediately placed in a sample cooler packed with ice to maintain an approximate temperature of 4 degrees Centigrade. Tools were thoroughly cleaned and decontaminated with the seven step decon process after each use. The samples remained in custody of SBG-EEG, Inc. until they were transferred to Test America Incorporated for analysis as documented in the Chain of Custody Record.

## XII. RECEPTORS

	Yes	No
<p>A. Are there any lakes, ponds, streams, or wetlands located within 1000 feet of the UST system?</p> <p>If yes, indicate type of receptor, distance, and direction on site map.</p>		X
<p>B. Are there any public, private, or irrigation water supply wells within 1000 feet of the UST system?</p> <p>If yes, indicate type of well, distance, and direction on site map.</p>		X
<p>C. Are there any underground structures (e.g., basements) Located within 100 feet of the UST system?</p> <p>If yes, indicate type of structure, distance, and direction on site map.</p>		X
<p>D. Are there any underground utilities (e.g., telephone, electricity, gas, water, sewer, storm drain) located within 100 feet of the UST system that could potentially come in contact with the contamination?</p> <p style="text-align: right;">*Sewer, water, electricity, cable, fiber optic &amp; geothermal</p> <p>If yes, indicate the type of utility, distance, and direction on the site map.</p>	*X	
<p>E. Has contaminated soil been identified at a depth less than 3 feet below land surface in an area that is not capped by asphalt or concrete?</p> <p>If yes, indicate the area of contaminated soil on the site map.</p>		X

### **XIII. SITE MAP**

**You must supply a scaled site map. It should include all buildings, road names, utilities, tank and dispenser island locations, labeled sample locations, extent of excavation, and any other pertinent information.**

(Attach Site Map Here)



**637 DAHLIA**



0 100 200 400 600 800 1,000  
 Feet

**SBG-EEG, Inc.**

7301 Rivers Ave., Suite 245  
 N. Charleston SC 29406-9643

Ph. (843) 573-7140

Drawn By: L. DiAsio

Dwg Date: June 2013

**FIGURE 1: LOCATION MAP**  
**637 DAHLIA DRIVE**  
**LAUREL BAY, BEAUFORT SC**



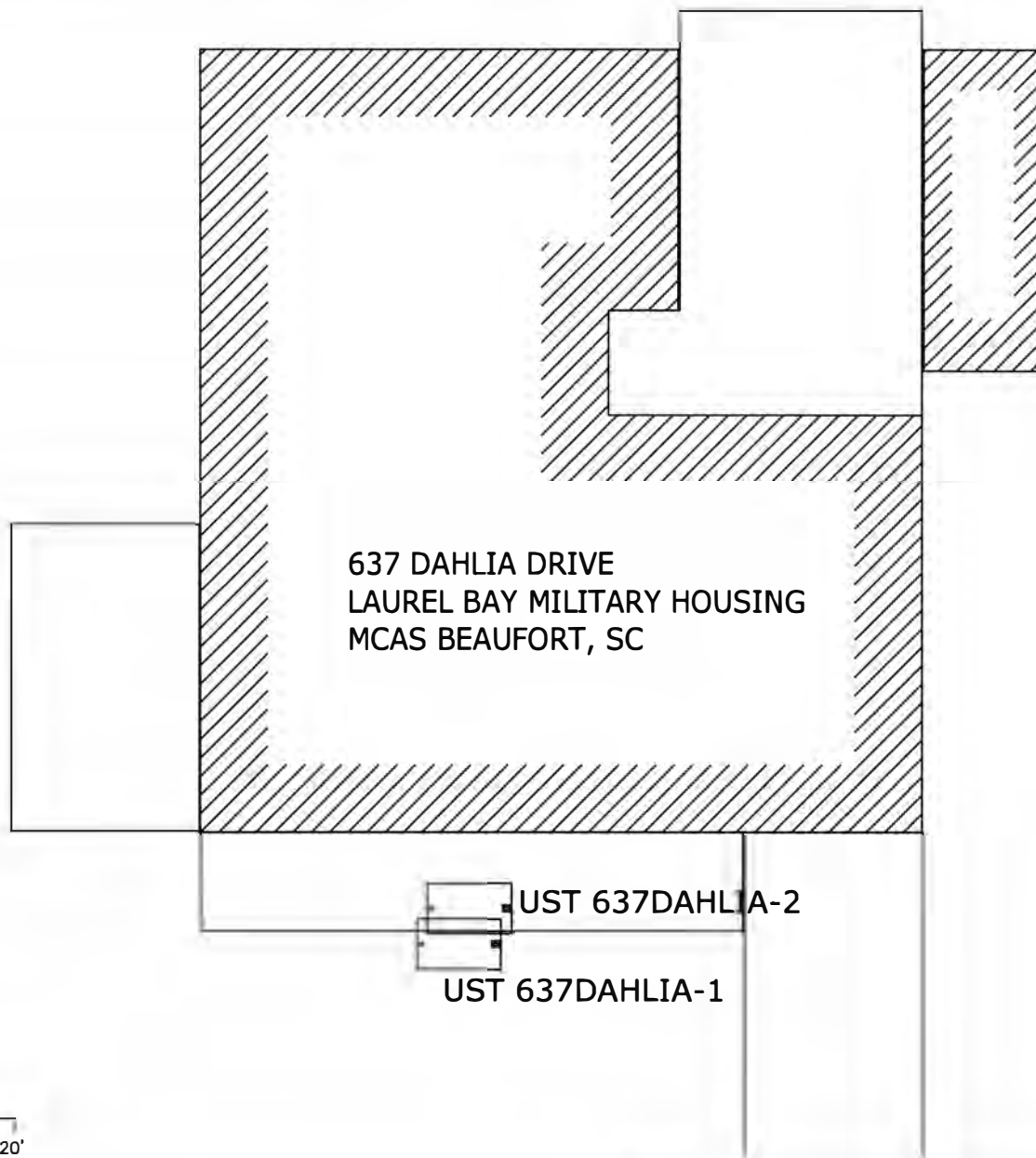

637 DAHLIA DRIVE  
LAUREL BAY MILITARY HOUSING  
MCAS BEAUFORT, SC

UST 637DAHLIA-2

UST 637DAHLIA-1

GRAPHIC SCALE

0 5' 10' 20'

**TANK DEPTH BELOW GRADE**

637DAHLIA-1 = 14"

637DAHLIA-2 = 36"

***SBG-EEG***

7301 RIVERS AVE., SUITE 245  
N. CHARLESTON SC 29406-9637  
(843) 573-7140

**FIGURE 2 SITE MAP**  
**637 DAHLIA DRIVE, LAUREL BAY**  
**MCAS BEAUFORT SC**

SCALE: GRAPHIC

DWG DATE JUNE 2013

637 DAHLIA DRIVE  
LAUREL BAY MILITARY HOUSING  
MCAS BEAUFORT, SC

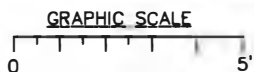
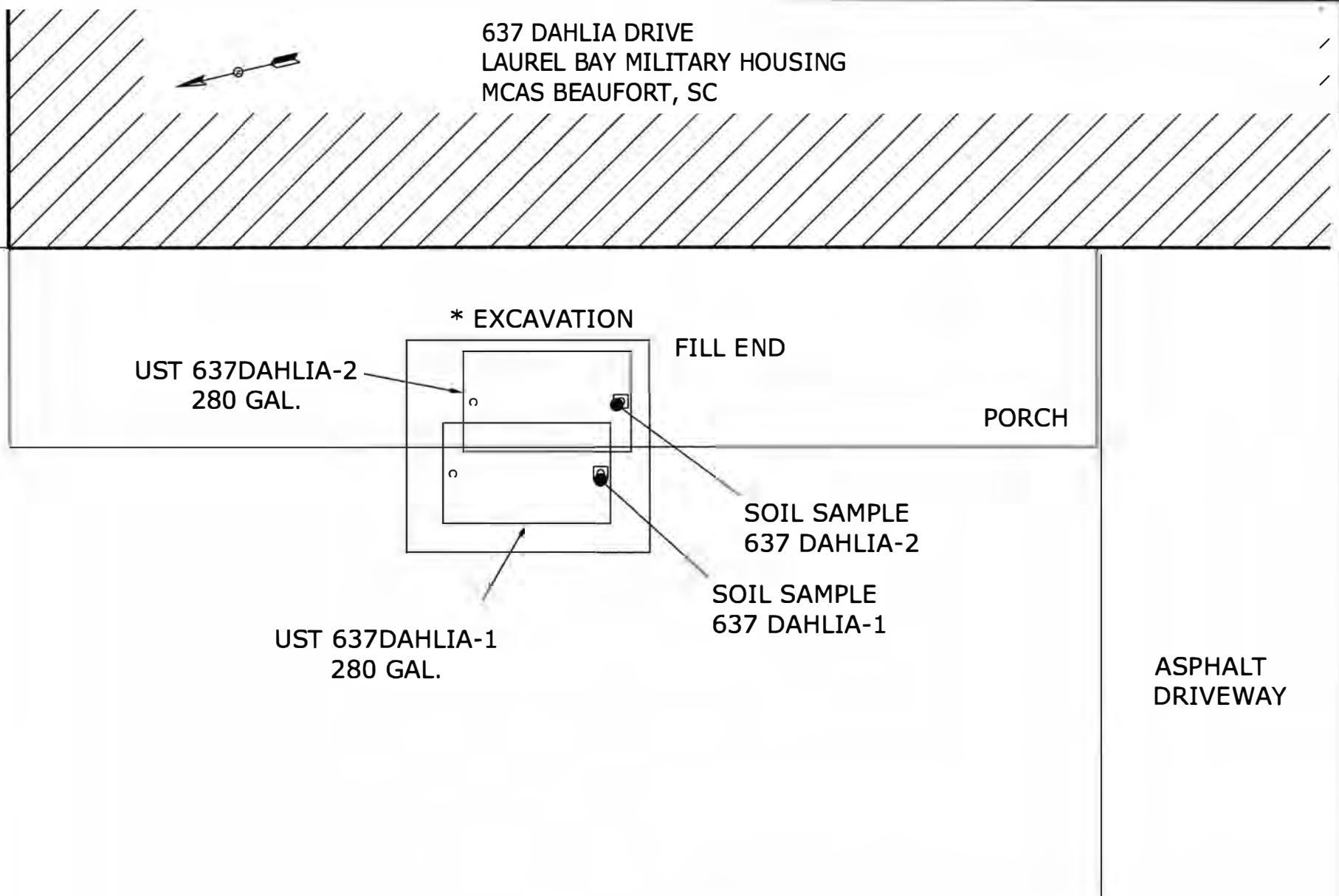

\* A PORTION OF THE PORCH WAS  
REMOVED TO FACILITATE TANK  
EXTRACTION.

**SBG-EEG**

7301 RIVERS AVE., SUITE 245  
N. CHARLESTON SC 29406-9637  
(843) 573-7140

FIGURE 3 UST SAMPLE LOCATIONS  
637 DAHLIA DRIVE, LAUREL BAY  
MCAS BEAUFORT SC

SCALE: GRAPHIC

DWG DATE JUNE 2013



Picture 1: Location of tanks at 637 Dahlia Drive.



Picture 2: UST 637Dahlia-1 excavation.





Picture 3: UST 637Dahlia-2 excavation.



Picture 4: Excavation site near completion of work.

#### XIV. SUMMARY OF ANALYSIS RESULTS

Enter the soil analytical data for each soil boring for all COC in the table below and on the following page.

CoC	UST	637Dahlia-1		637Dahlia-2			
Benzene		ND		ND			
Toluene		ND		ND			
Ethylbenzene		ND		ND			
Xylenes		ND		ND			
Naphthalene		ND		ND			
Benzo (a) anthracene		ND		ND			
Benzo (b) fluoranthene		ND		ND			
Benzo (k) fluoranthene		ND		ND			
Chrysene		ND		ND			
Dibenz (a, h) anthracene		ND		ND			
TPH (EPA 3550)							

CoC								
Benzene								
Toluene								
Ethylbenzene								
Xylenes								
Naphthalene								
Benzo (a) anthracene								
Benzo (b) fluoranthene								
Benzo (k) fluoranthene								
Chrysene								
Dibenz (a, h) anthracene								
TPH (EPA 3550)								

### SUMMARY OF ANALYSIS RESULTS (cont'd)

Enter the ground water analytical data for each sample for all CoC in the table below. If free product is present, indicate the measured thickness to the nearest 0.01 feet.

CoC	RBSL (µg/l)	W-1	W-2	W -3	W -4
<b>Free Product Thickness</b>	<b>None</b>				
<b>Benzene</b>	<b>5</b>				
<b>Toluene</b>	<b>1,000</b>				
<b>Ethylbenzene</b>	<b>700</b>				
<b>Xylenes</b>	<b>10,000</b>				
<b>Total BTEX</b>	<b>N/A</b>				
<b>MTBE</b>	<b>40</b>				
<b>Naphthalene</b>	<b>25</b>				
<b>Benzo (a) anthracene</b>	<b>10</b>				
<b>Benzo (b) flouranthene</b>	<b>10</b>				
<b>Benzo (k) flouranthene</b>	<b>10</b>				
<b>Chrysene</b>	<b>10</b>				
<b>Dibenz (a, h) anthracene</b>	<b>10</b>				
<b>EDB</b>	<b>.05</b>				
<b>1,2-DCA</b>	<b>5</b>				
<b>Lead</b>	<b>Site specific</b>				

## **XV. ANALYTICAL RESULTS**

**You must submit the laboratory report and chain-of-custody form for the samples. These samples must be analyzed by a South Carolina certified laboratory.**

(Attach Certified Analytical Results and Chain-of-Custody Here)  
(Please see Form #4)

# TestAmerica

THE LEADER IN ENVIRONMENTAL TESTING

## ANALYTICAL REPORT

TestAmerica Laboratories, Inc.

TestAmerica Nashville  
2960 Foster Creighton Drive  
Nashville, TN 37204  
Tel: (615)726-0177

TestAmerica Job ID: 490-27612-1

Client Project/Site: Laurel Bay Housing Project

For:

Small Business Group Inc.  
10179 Highway 78  
Ladson, South Carolina 29456

Attn: Tom McElwee

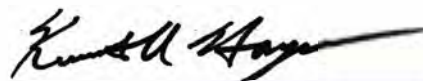

Authorized for release by:  
6/12/2013 10:35:03 AM

Ken Hayes, Project Manager I  
[ken.hayes@testamericainc.com](mailto:ken.hayes@testamericainc.com)

### LINKS

Review your project  
results through

**Total Access**

Have a Question?



Visit us at:

[www.testamericainc.com](http://www.testamericainc.com)

*The test results in this report meet all 2003 NELAC and 2009 TNI requirements for accredited parameters, exceptions are noted in this report. This report may not be reproduced except in full, and with written approval from the laboratory. For questions please contact the Project Manager at the e-mail address or telephone number listed on this page.*

*This report has been electronically signed and authorized by the signatory. Electronic signature is intended to be the legally binding equivalent of a traditionally handwritten signature.*

*Results relate only to the items tested and the sample(s) as received by the laboratory.*

1

2

3

4

5

6

7

8

9

10

11

12

13



# Table of Contents

Cover Page . . . . .	1
Table of Contents . . . . .	2
Sample Summary . . . . .	3
Case Narrative . . . . .	4
Definitions . . . . .	5
Client Sample Results . . . . .	6
QC Sample Results . . . . .	11
QC Association . . . . .	17
Chronicle . . . . .	19
Method Summary . . . . .	21
Certification Summary . . . . .	22
Chain of Custody . . . . .	23
Receipt Checklists . . . . .	25



## Sample Summary

Client: Small Business Group Inc.  
Project/Site: Laurel Bay Housing Project

TestAmerica Job ID: 490-27612-1

Lab Sample ID	Client Sample ID	Matrix	Collected	Received
490-27612-1	610 Dahlia	Solid	05/20/13 15:15	05/29/13 08:00
490-27612-2	637 Dahlia-1	Solid	05/21/13 13:45	05/29/13 08:00
490-27612-3	637 Dahlia-2	Solid	05/21/13 15:15	05/29/13 08:00
490-27612-4	265 Beech-1	Solid	05/22/13 16:15	05/29/13 08:00
490-27612-5	265 Beech-2	Solid	05/23/13 11:15	05/29/13 08:00

## Case Narrative

Client: Small Business Group Inc.  
Project/Site: Laurel Bay Housing Project

TestAmerica Job ID: 490-27612-1

**Job ID: 490-27612-1**

**Laboratory: TestAmerica Nashville**

### Narrative

**Job Narrative**  
**490-27612-1**

### Comments

No additional comments.

### Receipt

The samples were received on 5/29/2013 8:00 AM; the samples arrived in good condition, properly preserved and, where required, on ice. The temperature of the cooler at receipt was 1.9° C.

### GC/MS VOA

No analytical or quality issues were noted.

### GC/MS Semi VOA

No analytical or quality issues were noted.

### Organic Prep

Method(s) Moisture: The sample duplicate precision for the following sample associated with batch 82546 was outside control limits: (490-27616-1 DU).

No other analytical or quality issues were noted.

### VOA Prep

No analytical or quality issues were noted.

## Definitions/Glossary

Client: Small Business Group Inc.  
Project/Site: Laurel Bay Housing Project

TestAmerica Job ID: 490-27612-1

### Qualifiers

#### GC/MS VOA

Qualifier	Qualifier Description
J	Result is less than the RL but greater than or equal to the MDL and the concentration is an approximate value.

#### GC/MS Semi VOA

Qualifier	Qualifier Description
J	Result is less than the RL but greater than or equal to the MDL and the concentration is an approximate value.

### Glossary

Abbreviation	These commonly used abbreviations may or may not be present in this report.
▣	Listed under the "D" column to designate that the result is reported on a dry weight basis
%R	Percent Recovery
CNF	Contains no Free Liquid
DER	Duplicate error ratio (normalized absolute difference)
DL, RA, RE, IN	Indicates a Dilution, Re-analysis, Re-extraction, or additional Initial metals/anion analysis of the sample
DLC	Decision level concentration
MDA	Minimum detectable activity
EDL	Estimated Detection Limit
MDC	Minimum detectable concentration
MDL	Method Detection Limit
ML	Minimum Level (Dioxin)
ND	Not detected at the reporting limit (or MDL or EDL if shown)
PQL	Practical Quantitation Limit
QC	Quality Control
RER	Relative error ratio
RL	Reporting Limit or Requested Limit (Radiochemistry)
RPD	Relative Percent Difference, a measure of the relative difference between two points
TEF	Toxicity Equivalent Factor (Dioxin)
TEQ	Toxicity Equivalent Quotient (Dioxin)

# Client Sample Results

Client: Small Business Group Inc.  
Project/Site: Laurel Bay Housing Project

TestAmerica Job ID: 490-27612-1

Client Sample ID: 610 Dahlia

Lab Sample ID: 490-27612-1

Date Collected: 05/20/13 15:15

Matrix: Solid

Date Received: 05/29/13 08:00

Percent Solids: 91.9

## Method: 8260B - Volatile Organic Compounds (GC/MS)

Analyte	Result	Qualifier	RL	MDL	Unit	D	Prepared	Analyzed	Dil Fac
Benzene	ND		0.00215	0.000720	mg/Kg	✖	05/29/13 15:28	05/31/13 15:28	1
Ethylbenzene	ND		0.00215	0.000720	mg/Kg	✖	05/29/13 15:28	05/31/13 15:28	1
Naphthalene	ND		0.00537	0.00183	mg/Kg	✖	05/29/13 15:28	05/31/13 15:28	1
Toluene	ND		0.00215	0.000795	mg/Kg	✖	05/29/13 15:28	05/31/13 15:28	1
Xylenes, Total	ND		0.00537	0.000720	mg/Kg	✖	05/29/13 15:28	05/31/13 15:28	1

Surrogate	%Recovery	Qualifier	Limits	Prepared	Analyzed	Dil Fac
1,2-Dichloroethane-d4 (Surr)	104		70 - 130	05/29/13 15:28	05/31/13 15:28	1
4-Bromofluorobenzene (Surr)	99		70 - 130	05/29/13 15:28	05/31/13 15:28	1
Dibromofluoromethane (Surr)	101		70 - 130	05/29/13 15:28	05/31/13 15:28	1
Toluene-d8 (Surr)	98		70 - 130	05/29/13 15:28	05/31/13 15:28	1

## Method: 8270D - Semivolatile Organic Compounds (GC/MS)

Analyte	Result	Qualifier	RL	MDL	Unit	D	Prepared	Analyzed	Dil Fac
Acenaphthene	ND		0.0720	0.0108	mg/Kg	✖	05/30/13 05:50	05/31/13 19:40	1
Acenaphthylene	ND		0.0720	0.00968	mg/Kg	✖	05/30/13 05:50	05/31/13 19:40	1
Anthracene	ND		0.0720	0.00968	mg/Kg	✖	05/30/13 05:50	05/31/13 19:40	1
Benzo[a]anthracene	ND		0.0720	0.0161	mg/Kg	✖	05/30/13 05:50	05/31/13 19:40	1
Benzo[a]pyrene	ND		0.0720	0.0129	mg/Kg	✖	05/30/13 05:50	05/31/13 19:40	1
Benzo[b]fluoranthene	ND		0.0720	0.0129	mg/Kg	✖	05/30/13 05:50	05/31/13 19:40	1
Benzo[g,h,i]perylene	ND		0.0720	0.00968	mg/Kg	✖	05/30/13 05:50	05/31/13 19:40	1
Benzo[k]fluoranthene	ND		0.0720	0.0151	mg/Kg	✖	05/30/13 05:50	05/31/13 19:40	1
1-Methylnaphthalene	ND		0.0720	0.0151	mg/Kg	✖	05/30/13 05:50	05/31/13 19:40	1
Pyrene	ND		0.0720	0.0129	mg/Kg	✖	05/30/13 05:50	05/31/13 19:40	1
Phenanthrene	ND		0.0720	0.00968	mg/Kg	✖	05/30/13 05:50	05/31/13 19:40	1
Chrysene	ND		0.0720	0.00968	mg/Kg	✖	05/30/13 05:50	05/31/13 19:40	1
Dibenz(a,h)anthracene	ND		0.0720	0.00753	mg/Kg	✖	05/30/13 05:50	05/31/13 19:40	1
Fluoranthene	ND		0.0720	0.00968	mg/Kg	✖	05/30/13 05:50	05/31/13 19:40	1
Fluorene	ND		0.0720	0.0129	mg/Kg	✖	05/30/13 05:50	05/31/13 19:40	1
Indeno[1,2,3-cd]pyrene	ND		0.0720	0.0108	mg/Kg	✖	05/30/13 05:50	05/31/13 19:40	1
Naphthalene	ND		0.0720	0.00968	mg/Kg	✖	05/30/13 05:50	05/31/13 19:40	1
2-Methylnaphthalene	ND		0.0720	0.0172	mg/Kg	✖	05/30/13 05:50	05/31/13 19:40	1

Surrogate	%Recovery	Qualifier	Limits	Prepared	Analyzed	Dil Fac
2-Fluorobiphenyl (Surr)	46		29 - 120	05/30/13 05:50	05/31/13 19:40	1
Terphenyl-d14 (Surr)	59		13 - 120	05/30/13 05:50	05/31/13 19:40	1
Nitrobenzene-d5 (Surr)	47		27 - 120	05/30/13 05:50	05/31/13 19:40	1

## General Chemistry

Analyte	Result	Qualifier	RL	RL	Unit	D	Prepared	Analyzed	Dil Fac
Percent Solids	92		0.10	0.10	%			05/29/13 14:20	1

TestAmerica Nashville

# Client Sample Results

Client: Small Business Group Inc.  
Project/Site: Laurel Bay Housing Project

TestAmerica Job ID: 490-27612-1

**Client Sample ID: 637 Dahlia-1**

**Lab Sample ID: 490-27612-2**

Date Collected: 05/21/13 13:45

Matrix: Solid

Date Received: 05/29/13 08:00

Percent Solids: 77.2

## Method: 8260B - Volatile Organic Compounds (GC/MS)

Analyte	Result	Qualifier	RL	MDL	Unit	D	Prepared	Analyzed	Dil Fac
Benzene	ND		0.00218	0.000729	mg/Kg	✖	05/29/13 15:28	05/31/13 15:58	1
Ethylbenzene	ND		0.00218	0.000729	mg/Kg	✖	05/29/13 15:28	05/31/13 15:58	1
Naphthalene	ND		0.00544	0.00185	mg/Kg	✖	05/29/13 15:28	05/31/13 15:58	1
Toluene	ND		0.00218	0.000806	mg/Kg	✖	05/29/13 15:28	05/31/13 15:58	1
Xylenes, Total	ND		0.00544	0.000729	mg/Kg	✖	05/29/13 15:28	05/31/13 15:58	1

Surrogate	%Recovery	Qualifier	Limits	Prepared	Analyzed	Dil Fac
1,2-Dichloroethane-d4 (Surr)	102		70 - 130	05/29/13 15:28	05/31/13 15:58	1
4-Bromofluorobenzene (Surr)	103		70 - 130	05/29/13 15:28	05/31/13 15:58	1
Dibromofluoromethane (Surr)	97		70 - 130	05/29/13 15:28	05/31/13 15:58	1
Toluene-d8 (Surr)	100		70 - 130	05/29/13 15:28	05/31/13 15:58	1

## Method: 8270D - Semivolatile Organic Compounds (GC/MS)

Analyte	Result	Qualifier	RL	MDL	Unit	D	Prepared	Analyzed	Dil Fac
Acenaphthene	ND		0.0860	0.0128	mg/Kg	✖	05/30/13 05:50	05/31/13 20:01	1
Acenaphthylene	ND		0.0860	0.0116	mg/Kg	✖	05/30/13 05:50	05/31/13 20:01	1
Anthracene	ND		0.0860	0.0116	mg/Kg	✖	05/30/13 05:50	05/31/13 20:01	1
Benzo[a]anthracene	ND		0.0860	0.0193	mg/Kg	✖	05/30/13 05:50	05/31/13 20:01	1
Benzo[a]pyrene	ND		0.0860	0.0154	mg/Kg	✖	05/30/13 05:50	05/31/13 20:01	1
Benzo[b]fluoranthene	ND		0.0860	0.0154	mg/Kg	✖	05/30/13 05:50	05/31/13 20:01	1
Benzo[g,h,i]perylene	ND		0.0860	0.0116	mg/Kg	✖	05/30/13 05:50	05/31/13 20:01	1
Benzo[k]fluoranthene	ND		0.0860	0.0180	mg/Kg	✖	05/30/13 05:50	05/31/13 20:01	1
1-Methylnaphthalene	ND		0.0860	0.0180	mg/Kg	✖	05/30/13 05:50	05/31/13 20:01	1
Pyrene	ND		0.0860	0.0154	mg/Kg	✖	05/30/13 05:50	05/31/13 20:01	1
Phenanthrene	ND		0.0860	0.0116	mg/Kg	✖	05/30/13 05:50	05/31/13 20:01	1
Chrysene	ND		0.0860	0.0116	mg/Kg	✖	05/30/13 05:50	05/31/13 20:01	1
Dibenz(a,h)anthracene	ND		0.0860	0.00899	mg/Kg	✖	05/30/13 05:50	05/31/13 20:01	1
Fluoranthene	ND		0.0860	0.0116	mg/Kg	✖	05/30/13 05:50	05/31/13 20:01	1
Fluorene	ND		0.0860	0.0154	mg/Kg	✖	05/30/13 05:50	05/31/13 20:01	1
Indeno[1,2,3-cd]pyrene	ND		0.0860	0.0128	mg/Kg	✖	05/30/13 05:50	05/31/13 20:01	1
Naphthalene	ND		0.0860	0.0116	mg/Kg	✖	05/30/13 05:50	05/31/13 20:01	1
2-Methylnaphthalene	ND		0.0860	0.0205	mg/Kg	✖	05/30/13 05:50	05/31/13 20:01	1

Surrogate	%Recovery	Qualifier	Limits	Prepared	Analyzed	Dil Fac
2-Fluorobiphenyl (Surr)	38		29 - 120	05/30/13 05:50	05/31/13 20:01	1
Terphenyl-d14 (Surr)	51		13 - 120	05/30/13 05:50	05/31/13 20:01	1
Nitrobenzene-d5 (Surr)	44		27 - 120	05/30/13 05:50	05/31/13 20:01	1

## General Chemistry

Analyte	Result	Qualifier	RL	RL	Unit	D	Prepared	Analyzed	Dil Fac
Percent Solids	77		0.10	0.10	%			05/29/13 14:20	1

TestAmerica Nashville

# Client Sample Results

Client: Small Business Group Inc.  
Project/Site: Laurel Bay Housing Project

TestAmerica Job ID: 490-27612-1

**Client Sample ID: 637 Dahlia-2**

**Lab Sample ID: 490-27612-3**

Date Collected: 05/21/13 15:15

Matrix: Solid

Date Received: 05/29/13 08:00

Percent Solids: 81.9

## Method: 8260B - Volatile Organic Compounds (GC/MS)

Analyte	Result	Qualifier	RL	MDL	Unit	D	Prepared	Analyzed	Dil Fac
Benzene	ND		0.00202	0.000677	mg/Kg	✱	05/29/13 15:28	05/31/13 16:29	1
Ethylbenzene	ND		0.00202	0.000677	mg/Kg	✱	05/29/13 15:28	05/31/13 16:29	1
Naphthalene	ND		0.00505	0.00172	mg/Kg	✱	05/29/13 15:28	05/31/13 16:29	1
Toluene	ND		0.00202	0.000748	mg/Kg	✱	05/29/13 15:28	05/31/13 16:29	1
Xylenes, Total	ND		0.00505	0.000677	mg/Kg	✱	05/29/13 15:28	05/31/13 16:29	1

Surrogate	%Recovery	Qualifier	Limits	Prepared	Analyzed	Dil Fac
1,2-Dichloroethane-d4 (Surr)	100		70 - 130	05/29/13 15:28	05/31/13 16:29	1
4-Bromofluorobenzene (Surr)	101		70 - 130	05/29/13 15:28	05/31/13 16:29	1
Dibromofluoromethane (Surr)	97		70 - 130	05/29/13 15:28	05/31/13 16:29	1
Toluene-d8 (Surr)	98		70 - 130	05/29/13 15:28	05/31/13 16:29	1

## Method: 8270D - Semivolatile Organic Compounds (GC/MS)

Analyte	Result	Qualifier	RL	MDL	Unit	D	Prepared	Analyzed	Dil Fac
Acenaphthene	ND		0.0810	0.0121	mg/Kg	✱	05/30/13 05:50	05/31/13 20:22	1
Acenaphthylene	ND		0.0810	0.0109	mg/Kg	✱	05/30/13 05:50	05/31/13 20:22	1
Anthracene	ND		0.0810	0.0109	mg/Kg	✱	05/30/13 05:50	05/31/13 20:22	1
Benzo[a]anthracene	ND		0.0810	0.0181	mg/Kg	✱	05/30/13 05:50	05/31/13 20:22	1
Benzo[a]pyrene	ND		0.0810	0.0145	mg/Kg	✱	05/30/13 05:50	05/31/13 20:22	1
Benzo[b]fluoranthene	ND		0.0810	0.0145	mg/Kg	✱	05/30/13 05:50	05/31/13 20:22	1
Benzo[g,h,i]perylene	ND		0.0810	0.0109	mg/Kg	✱	05/30/13 05:50	05/31/13 20:22	1
Benzo[k]fluoranthene	ND		0.0810	0.0169	mg/Kg	✱	05/30/13 05:50	05/31/13 20:22	1
1-Methylnaphthalene	ND		0.0810	0.0169	mg/Kg	✱	05/30/13 05:50	05/31/13 20:22	1
Pyrene	ND		0.0810	0.0145	mg/Kg	✱	05/30/13 05:50	05/31/13 20:22	1
Phenanthrene	ND		0.0810	0.0109	mg/Kg	✱	05/30/13 05:50	05/31/13 20:22	1
Chrysene	ND		0.0810	0.0109	mg/Kg	✱	05/30/13 05:50	05/31/13 20:22	1
Dibenz(a,h)anthracene	ND		0.0810	0.00846	mg/Kg	✱	05/30/13 05:50	05/31/13 20:22	1
Fluoranthene	ND		0.0810	0.0109	mg/Kg	✱	05/30/13 05:50	05/31/13 20:22	1
Fluorene	ND		0.0810	0.0145	mg/Kg	✱	05/30/13 05:50	05/31/13 20:22	1
Indeno[1,2,3-cd]pyrene	ND		0.0810	0.0121	mg/Kg	✱	05/30/13 05:50	05/31/13 20:22	1
Naphthalene	ND		0.0810	0.0109	mg/Kg	✱	05/30/13 05:50	05/31/13 20:22	1
2-Methylnaphthalene	ND		0.0810	0.0193	mg/Kg	✱	05/30/13 05:50	05/31/13 20:22	1

Surrogate	%Recovery	Qualifier	Limits	Prepared	Analyzed	Dil Fac
2-Fluorobiphenyl (Surr)	57		29 - 120	05/30/13 05:50	05/31/13 20:22	1
Terphenyl-d14 (Surr)	78		13 - 120	05/30/13 05:50	05/31/13 20:22	1
Nitrobenzene-d5 (Surr)	59		27 - 120	05/30/13 05:50	05/31/13 20:22	1

## General Chemistry

Analyte	Result	Qualifier	RL	RL	Unit	D	Prepared	Analyzed	Dil Fac
Percent Solids	82		0.10	0.10	%			05/29/13 14:20	1

TestAmerica Nashville



# Client Sample Results

Client: Small Business Group Inc.  
Project/Site: Laurel Bay Housing Project

TestAmerica Job ID: 490-27612-1

**Client Sample ID: 265 Beech-1**

**Lab Sample ID: 490-27612-4**

Date Collected: 05/22/13 16:15

Matrix: Solid

Date Received: 05/29/13 08:00

Percent Solids: 77.3

## Method: 8260B - Volatile Organic Compounds (GC/MS)

Analyte	Result	Qualifier	RL	MDL	Unit	D	Prepared	Analyzed	Dil Fac
Benzene	ND		0.00192	0.000644	mg/Kg	✖	05/29/13 15:28	05/31/13 16:59	1
Ethylbenzene	0.00106	J	0.00192	0.000644	mg/Kg	✖	05/29/13 15:28	05/31/13 16:59	1
Naphthalene	0.0207		0.00481	0.00163	mg/Kg	✖	05/29/13 15:28	05/31/13 16:59	1
Toluene	ND		0.00192	0.000711	mg/Kg	✖	05/29/13 15:28	05/31/13 16:59	1
Xylenes, Total	0.000677	J	0.00481	0.000644	mg/Kg	✖	05/29/13 15:28	05/31/13 16:59	1

Surrogate	%Recovery	Qualifier	Limits	Prepared	Analyzed	Dil Fac
1,2-Dichloroethane-d4 (Surr)	104		70 - 130	05/29/13 15:28	05/31/13 16:59	1
4-Bromofluorobenzene (Surr)	97		70 - 130	05/29/13 15:28	05/31/13 16:59	1
Dibromofluoromethane (Surr)	96		70 - 130	05/29/13 15:28	05/31/13 16:59	1
Toluene-d8 (Surr)	94		70 - 130	05/29/13 15:28	05/31/13 16:59	1

## Method: 8270D - Semivolatile Organic Compounds (GC/MS)

Analyte	Result	Qualifier	RL	MDL	Unit	D	Prepared	Analyzed	Dil Fac
Acenaphthene	ND		0.0867	0.0129	mg/Kg	✖	05/30/13 05:50	05/31/13 20:43	1
Acenaphthylene	ND		0.0867	0.0116	mg/Kg	✖	05/30/13 05:50	05/31/13 20:43	1
Anthracene	ND		0.0867	0.0116	mg/Kg	✖	05/30/13 05:50	05/31/13 20:43	1
Benzo[a]anthracene	ND		0.0867	0.0194	mg/Kg	✖	05/30/13 05:50	05/31/13 20:43	1
Benzo[a]pyrene	ND		0.0867	0.0155	mg/Kg	✖	05/30/13 05:50	05/31/13 20:43	1
Benzo[b]fluoranthene	ND		0.0867	0.0155	mg/Kg	✖	05/30/13 05:50	05/31/13 20:43	1
Benzo[g,h,i]perylene	ND		0.0867	0.0116	mg/Kg	✖	05/30/13 05:50	05/31/13 20:43	1
Benzo[k]fluoranthene	ND		0.0867	0.0181	mg/Kg	✖	05/30/13 05:50	05/31/13 20:43	1
1-Methylnaphthalene	0.0525	J	0.0867	0.0181	mg/Kg	✖	05/30/13 05:50	05/31/13 20:43	1
Pyrene	0.0661	J	0.0867	0.0155	mg/Kg	✖	05/30/13 05:50	05/31/13 20:43	1
Phenanthrene	0.110		0.0867	0.0116	mg/Kg	✖	05/30/13 05:50	05/31/13 20:43	1
Chrysene	ND		0.0867	0.0116	mg/Kg	✖	05/30/13 05:50	05/31/13 20:43	1
Dibenz(a,h)anthracene	ND		0.0867	0.00906	mg/Kg	✖	05/30/13 05:50	05/31/13 20:43	1
Fluoranthene	0.0875		0.0867	0.0116	mg/Kg	✖	05/30/13 05:50	05/31/13 20:43	1
Fluorene	ND		0.0867	0.0155	mg/Kg	✖	05/30/13 05:50	05/31/13 20:43	1
Indeno[1,2,3-cd]pyrene	ND		0.0867	0.0129	mg/Kg	✖	05/30/13 05:50	05/31/13 20:43	1
Naphthalene	ND		0.0867	0.0116	mg/Kg	✖	05/30/13 05:50	05/31/13 20:43	1
2-Methylnaphthalene	0.0768	J	0.0867	0.0207	mg/Kg	✖	05/30/13 05:50	05/31/13 20:43	1

Surrogate	%Recovery	Qualifier	Limits	Prepared	Analyzed	Dil Fac
2-Fluorobiphenyl (Surr)	40		29 - 120	05/30/13 05:50	05/31/13 20:43	1
Terphenyl-d14 (Surr)	66		13 - 120	05/30/13 05:50	05/31/13 20:43	1
Nitrobenzene-d5 (Surr)	46		27 - 120	05/30/13 05:50	05/31/13 20:43	1

## General Chemistry

Analyte	Result	Qualifier	RL	RL	Unit	D	Prepared	Analyzed	Dil Fac
Percent Solids	77		0.10	0.10	%			05/29/13 14:20	1

TestAmerica Nashville



# Client Sample Results

Client: Small Business Group Inc.  
Project/Site: Laurel Bay Housing Project

TestAmerica Job ID: 490-27612-1

**Client Sample ID: 265 Beech-2**

Date Collected: 05/23/13 11:15

Date Received: 05/29/13 08:00

**Lab Sample ID: 490-27612-5**

Matrix: Solid

Percent Solids: 76.7

## Method: 8260B - Volatile Organic Compounds (GC/MS)

Analyte	Result	Qualifier	RL	MDL	Unit	D	Prepared	Analyzed	Dil Fac
Benzene	ND		0.00192	0.000642	mg/Kg	✖	05/29/13 15:28	05/31/13 17:29	1
Ethylbenzene	0.0523		0.00192	0.000642	mg/Kg	✖	05/29/13 15:28	05/31/13 17:29	1
Naphthalene	9.73		0.339	0.115	mg/Kg	✖	05/29/13 15:26	06/02/13 04:28	1
Toluene	ND		0.00192	0.000710	mg/Kg	✖	05/29/13 15:28	05/31/13 17:29	1
Xylenes, Total	0.0291		0.00479	0.000642	mg/Kg	✖	05/29/13 15:28	05/31/13 17:29	1

Surrogate	%Recovery	Qualifier	Limits	Prepared	Analyzed	Dil Fac
1,2-Dichloroethane-d4 (Surr)	102		70 - 130	05/29/13 15:28	05/31/13 17:29	1
1,2-Dichloroethane-d4 (Surr)	86		70 - 130	05/29/13 15:26	06/02/13 04:28	1
4-Bromofluorobenzene (Surr)	108		70 - 130	05/29/13 15:28	05/31/13 17:29	1
4-Bromofluorobenzene (Surr)	113		70 - 130	05/29/13 15:26	06/02/13 04:28	1
Dibromofluoromethane (Surr)	94		70 - 130	05/29/13 15:28	05/31/13 17:29	1
Dibromofluoromethane (Surr)	86		70 - 130	05/29/13 15:26	06/02/13 04:28	1
Toluene-d8 (Surr)	97		70 - 130	05/29/13 15:28	05/31/13 17:29	1
Toluene-d8 (Surr)	100		70 - 130	05/29/13 15:26	06/02/13 04:28	1

## Method: 8270D - Semivolatile Organic Compounds (GC/MS)

Analyte	Result	Qualifier	RL	MDL	Unit	D	Prepared	Analyzed	Dil Fac
Acenaphthene	0.0451	J	0.0866	0.0129	mg/Kg	✖	05/30/13 05:50	05/31/13 21:03	1
Acenaphthylene	ND		0.0866	0.0116	mg/Kg	✖	05/30/13 05:50	05/31/13 21:03	1
Anthracene	0.0538	J	0.0866	0.0116	mg/Kg	✖	05/30/13 05:50	05/31/13 21:03	1
Benzo[a]anthracene	ND		0.0866	0.0194	mg/Kg	✖	05/30/13 05:50	05/31/13 21:03	1
Benzo[a]pyrene	ND		0.0866	0.0155	mg/Kg	✖	05/30/13 05:50	05/31/13 21:03	1
Benzo[b]fluoranthene	ND		0.0866	0.0155	mg/Kg	✖	05/30/13 05:50	05/31/13 21:03	1
Benzo[g,h,i]perylene	ND		0.0866	0.0116	mg/Kg	✖	05/30/13 05:50	05/31/13 21:03	1
Benzo[k]fluoranthene	ND		0.0866	0.0181	mg/Kg	✖	05/30/13 05:50	05/31/13 21:03	1
1-Methylnaphthalene	0.506		0.0866	0.0181	mg/Kg	✖	05/30/13 05:50	05/31/13 21:03	1
Pyrene	0.0631	J	0.0866	0.0155	mg/Kg	✖	05/30/13 05:50	05/31/13 21:03	1
Phenanthrene	0.462		0.0866	0.0116	mg/Kg	✖	05/30/13 05:50	05/31/13 21:03	1
Chrysene	ND		0.0866	0.0116	mg/Kg	✖	05/30/13 05:50	05/31/13 21:03	1
Dibenz(a,h)anthracene	ND		0.0866	0.00905	mg/Kg	✖	05/30/13 05:50	05/31/13 21:03	1
Fluoranthene	ND		0.0866	0.0116	mg/Kg	✖	05/30/13 05:50	05/31/13 21:03	1
Fluorene	0.244		0.0866	0.0155	mg/Kg	✖	05/30/13 05:50	05/31/13 21:03	1
Indeno[1,2,3-cd]pyrene	ND		0.0866	0.0129	mg/Kg	✖	05/30/13 05:50	05/31/13 21:03	1
Naphthalene	0.0739	J	0.0866	0.0116	mg/Kg	✖	05/30/13 05:50	05/31/13 21:03	1
2-Methylnaphthalene	0.631		0.0866	0.0207	mg/Kg	✖	05/30/13 05:50	05/31/13 21:03	1

Surrogate	%Recovery	Qualifier	Limits	Prepared	Analyzed	Dil Fac
2-Fluorobiphenyl (Surr)	61		29 - 120	05/30/13 05:50	05/31/13 21:03	1
Terphenyl-d14 (Surr)	89		13 - 120	05/30/13 05:50	05/31/13 21:03	1
Nitrobenzene-d5 (Surr)	60		27 - 120	05/30/13 05:50	05/31/13 21:03	1

## General Chemistry

Analyte	Result	Qualifier	RL	RL	Unit	D	Prepared	Analyzed	Dil Fac
Percent Solids	77		0.10	0.10	%			05/29/13 14:20	1

TestAmerica Nashville

# QC Sample Results

Client: Small Business Group Inc.  
Project/Site: Laurel Bay Housing Project

TestAmerica Job ID: 490-27612-1

## Method: 8260B - Volatile Organic Compounds (GC/MS)

Lab Sample ID: 490-27504-A-12-D MS

Matrix: Solid

Analysis Batch: 82946

Client Sample ID: Matrix Spike

Prep Type: Total/NA

Prep Batch: 81976

Analyte	Sample Result	Sample Qualifier	Spike Added	MS Result	MS Qualifier	Unit	D	%Rec	%Rec. Limits
Benzene	ND		0.0358	0.02695		mg/Kg		75	31 - 143
Ethylbenzene	ND		0.0358	0.01842		mg/Kg		51	23 - 161
Naphthalene	ND		0.0358	0.02448		mg/Kg		68	10 - 176
Toluene	ND		0.0358	0.02174		mg/Kg		61	30 - 155
Xylenes, Total	ND		0.107	0.05312		mg/Kg		50	25 - 162

Surrogate	MS %Recovery	MS Qualifier	Limits
1,2-Dichloroethane-d4 (Surr)	98		70 - 130
4-Bromofluorobenzene (Surr)	104		70 - 130
Dibromofluoromethane (Surr)	98		70 - 130
Toluene-d8 (Surr)	95		70 - 130

Lab Sample ID: 490-27504-A-12-E MSD

Matrix: Solid

Analysis Batch: 82946

Client Sample ID: Matrix Spike Duplicate

Prep Type: Total/NA

Prep Batch: 81976

Analyte	Sample Result	Sample Qualifier	Spike Added	MSD Result	MSD Qualifier	Unit	D	%Rec	%Rec. Limits	RPD	Limit
Benzene	ND		0.0412	0.02089		mg/Kg		51	31 - 143	25	50
Ethylbenzene	ND		0.0412	0.01421		mg/Kg		35	23 - 161	26	50
Naphthalene	ND		0.0412	0.02124		mg/Kg		52	10 - 176	14	50
Toluene	ND		0.0412	0.01703		mg/Kg		41	30 - 155	24	50
Xylenes, Total	ND		0.124	0.04185		mg/Kg		34	25 - 162	24	50

Surrogate	MSD %Recovery	MSD Qualifier	Limits
1,2-Dichloroethane-d4 (Surr)	103		70 - 130
4-Bromofluorobenzene (Surr)	97		70 - 130
Dibromofluoromethane (Surr)	96		70 - 130
Toluene-d8 (Surr)	97		70 - 130

Lab Sample ID: MB 490-82946/6

Matrix: Solid

Analysis Batch: 82946

Client Sample ID: Method Blank

Prep Type: Total/NA

Analyte	MB Result	MB Qualifier	RL	MDL	Unit	D	Prepared	Analyzed	Dil Fac
Benzene	ND		0.00200	0.000670	mg/Kg			05/31/13 08:56	1
Ethylbenzene	ND		0.00200	0.000670	mg/Kg			05/31/13 08:56	1
Naphthalene	ND		0.00500	0.00170	mg/Kg			05/31/13 08:56	1
Toluene	ND		0.00200	0.000740	mg/Kg			05/31/13 08:56	1
Xylenes, Total	ND		0.00500	0.000670	mg/Kg			05/31/13 08:56	1

Surrogate	MB %Recovery	MB Qualifier	Limits	Prepared	Analyzed	Dil Fac
1,2-Dichloroethane-d4 (Surr)	101		70 - 130		05/31/13 08:56	1
4-Bromofluorobenzene (Surr)	101		70 - 130		05/31/13 08:56	1
Dibromofluoromethane (Surr)	96		70 - 130		05/31/13 08:56	1
Toluene-d8 (Surr)	101		70 - 130		05/31/13 08:56	1

TestAmerica Nashville

# QC Sample Results

Client: Small Business Group Inc.  
Project/Site: Laurel Bay Housing Project

TestAmerica Job ID: 490-27612-1

## Method: 8260B - Volatile Organic Compounds (GC/MS) (Continued)

Lab Sample ID: LCS 490-82946/3

Matrix: Solid

Analysis Batch: 82946

Client Sample ID: Lab Control Sample

Prep Type: Total/NA

Analyte	Spike Added	LCS Result	LCS Qualifier	Unit	D	%Rec	%Rec. Limits	
Benzene	0.0500	0.04799		mg/Kg		96	75 - 127	
Ethylbenzene	0.0500	0.04855		mg/Kg		97	80 - 134	
Naphthalene	0.0500	0.04945		mg/Kg		99	69 - 150	
Toluene	0.0500	0.04879		mg/Kg		98	80 - 132	
Xylenes, Total	0.150	0.1445		mg/Kg		96	80 - 137	

Surrogate	LCS LCS		Limits
	%Recovery	Qualifier	
1,2-Dichloroethane-d4 (Surr)	95		70 - 130
4-Bromofluorobenzene (Surr)	100		70 - 130
Dibromofluoromethane (Surr)	95		70 - 130
Toluene-d8 (Surr)	99		70 - 130

Lab Sample ID: LCSD 490-82946/4

Matrix: Solid

Analysis Batch: 82946

Client Sample ID: Lab Control Sample Dup

Prep Type: Total/NA

Analyte	Spike Added	LCSD Result	LCSD Qualifier	Unit	D	%Rec	%Rec. Limits		RPD	
									RPD	Limit
Benzene	0.0500	0.05170		mg/Kg		103	75 - 127		7	50
Ethylbenzene	0.0500	0.05188		mg/Kg		104	80 - 134		7	50
Naphthalene	0.0500	0.05564		mg/Kg		111	69 - 150		12	50
Toluene	0.0500	0.05183		mg/Kg		104	80 - 132		6	50
Xylenes, Total	0.150	0.1539		mg/Kg		103	80 - 137		6	50

Surrogate	LCSD LCSD		Limits
	%Recovery	Qualifier	
1,2-Dichloroethane-d4 (Surr)	96		70 - 130
4-Bromofluorobenzene (Surr)	107		70 - 130
Dibromofluoromethane (Surr)	96		70 - 130
Toluene-d8 (Surr)	97		70 - 130

Lab Sample ID: MB 490-83308/7

Matrix: Solid

Analysis Batch: 83308

Client Sample ID: Method Blank

Prep Type: Total/NA

Analyte	MB MB		RL	MDL	Unit	D	Prepared	Analyzed	Dil Fac
	Result	Qualifier							
Benzene	ND		0.100	0.0340	mg/Kg			06/02/13 02:27	1
Ethylbenzene	ND		0.100	0.0340	mg/Kg			06/02/13 02:27	1
Naphthalene	ND		0.250	0.0850	mg/Kg			06/02/13 02:27	1
Toluene	ND		0.100	0.0370	mg/Kg			06/02/13 02:27	1
Xylenes, Total	ND		0.250	0.0340	mg/Kg			06/02/13 02:27	1

Surrogate	MB MB		Limits	Prepared	Analyzed	Dil Fac
	%Recovery	Qualifier				
1,2-Dichloroethane-d4 (Surr)	103		70 - 130		06/02/13 02:27	1
4-Bromofluorobenzene (Surr)	108		70 - 130		06/02/13 02:27	1
Dibromofluoromethane (Surr)	94		70 - 130		06/02/13 02:27	1
Toluene-d8 (Surr)	99		70 - 130		06/02/13 02:27	1

TestAmerica Nashville

## QC Sample Results

Client: Small Business Group Inc.  
Project/Site: Laurel Bay Housing Project

TestAmerica Job ID: 490-27612-1

### Method: 8260B - Volatile Organic Compounds (GC/MS) (Continued)

Lab Sample ID: LCS 490-83308/3

Matrix: Solid

Analysis Batch: 83308

Client Sample ID: Lab Control Sample

Prep Type: Total/NA

Analyte	Spike	LCS	LCS	Unit	D	%Rec	%Rec.
	Added	Result	Qualifier				Limits
Benzene	0.0500	0.05222		mg/Kg		104	75 - 127
Ethylbenzene	0.0500	0.05120		mg/Kg		102	80 - 134
Naphthalene	0.0500	0.05912		mg/Kg		118	69 - 150
Toluene	0.0500	0.05219		mg/Kg		104	80 - 132
Xylenes, Total	0.150	0.1508		mg/Kg		101	80 - 137

Surrogate	LCS	LCS	Limits
	%Recovery	Qualifier	
1,2-Dichloroethane-d4 (Surr)	97		70 - 130
4-Bromofluorobenzene (Surr)	110		70 - 130
Dibromofluoromethane (Surr)	97		70 - 130
Toluene-d8 (Surr)	96		70 - 130

Lab Sample ID: LCSD 490-83308/4

Matrix: Solid

Analysis Batch: 83308

Client Sample ID: Lab Control Sample Dup

Prep Type: Total/NA

Analyte	Spike	LCSD	LCSD	Unit	D	%Rec	%Rec.	RPD	Limit
	Added	Result	Qualifier				Limits		
Benzene	0.0500	0.05358		mg/Kg		107	75 - 127	3	50
Ethylbenzene	0.0500	0.05216		mg/Kg		104	80 - 134	2	50
Naphthalene	0.0500	0.06683		mg/Kg		134	69 - 150	12	50
Toluene	0.0500	0.05305		mg/Kg		106	80 - 132	2	50
Xylenes, Total	0.150	0.1548		mg/Kg		103	80 - 137	3	50

Surrogate	LCSD	LCSD	Limits
	%Recovery	Qualifier	
1,2-Dichloroethane-d4 (Surr)	97		70 - 130
4-Bromofluorobenzene (Surr)	113		70 - 130
Dibromofluoromethane (Surr)	99		70 - 130
Toluene-d8 (Surr)	95		70 - 130

### Method: 8270D - Semivolatile Organic Compounds (GC/MS)

Lab Sample ID: MB 490-82627/1-A

Matrix: Solid

Analysis Batch: 83012

Client Sample ID: Method Blank

Prep Type: Total/NA

Prep Batch: 82627

Analyte	MB	MB	RL	MDL	Unit	D	Prepared	Analyzed	Dil Fac
	Result	Qualifier							
Acenaphthene	ND		0.0670	0.0100	mg/Kg		05/30/13 05:50	05/31/13 10:14	1
Acenaphthylene	ND		0.0670	0.00900	mg/Kg		05/30/13 05:50	05/31/13 10:14	1
Anthracene	ND		0.0670	0.00900	mg/Kg		05/30/13 05:50	05/31/13 10:14	1
Benzo[a]anthracene	ND		0.0670	0.0150	mg/Kg		05/30/13 05:50	05/31/13 10:14	1
Benzo[a]pyrene	ND		0.0670	0.0120	mg/Kg		05/30/13 05:50	05/31/13 10:14	1
Benzo[b]fluoranthene	ND		0.0670	0.0120	mg/Kg		05/30/13 05:50	05/31/13 10:14	1
Benzo[g,h,i]perylene	ND		0.0670	0.00900	mg/Kg		05/30/13 05:50	05/31/13 10:14	1
Benzo[k]fluoranthene	ND		0.0670	0.0140	mg/Kg		05/30/13 05:50	05/31/13 10:14	1
1-Methylnaphthalene	ND		0.0670	0.0140	mg/Kg		05/30/13 05:50	05/31/13 10:14	1
Pyrene	ND		0.0670	0.0120	mg/Kg		05/30/13 05:50	05/31/13 10:14	1
Phenanthrene	ND		0.0670	0.00900	mg/Kg		05/30/13 05:50	05/31/13 10:14	1

TestAmerica Nashville

# QC Sample Results

Client: Small Business Group Inc.  
Project/Site: Laurel Bay Housing Project

TestAmerica Job ID: 490-27612-1

## Method: 8270D - Semivolatile Organic Compounds (GC/MS) (Continued)

Lab Sample ID: MB 490-82627/1-A

Matrix: Solid

Analysis Batch: 83012

Client Sample ID: Method Blank

Prep Type: Total/NA

Prep Batch: 82627

Analyte	MB Result	MB Qualifier	RL	MDL	Unit	D	Prepared	Analyzed	Dil Fac
Chrysene	ND		0.0670	0.00900	mg/Kg		05/30/13 05:50	05/31/13 10:14	1
Dibenz(a,h)anthracene	ND		0.0670	0.00700	mg/Kg		05/30/13 05:50	05/31/13 10:14	1
Fluoranthene	ND		0.0670	0.00900	mg/Kg		05/30/13 05:50	05/31/13 10:14	1
Fluorene	ND		0.0670	0.0120	mg/Kg		05/30/13 05:50	05/31/13 10:14	1
Indeno[1,2,3-cd]pyrene	ND		0.0670	0.0100	mg/Kg		05/30/13 05:50	05/31/13 10:14	1
Naphthalene	ND		0.0670	0.00900	mg/Kg		05/30/13 05:50	05/31/13 10:14	1
2-Methylnaphthalene	ND		0.0670	0.0160	mg/Kg		05/30/13 05:50	05/31/13 10:14	1

Surrogate	MB %Recovery	MB Qualifier	Limits	Prepared	Analyzed	Dil Fac
2-Fluorobiphenyl (Surr)	72		29 - 120	05/30/13 05:50	05/31/13 10:14	1
Terphenyl-d14 (Surr)	88		13 - 120	05/30/13 05:50	05/31/13 10:14	1
Nitrobenzene-d5 (Surr)	70		27 - 120	05/30/13 05:50	05/31/13 10:14	1

Lab Sample ID: LCS 490-82627/2-A

Matrix: Solid

Analysis Batch: 83012

Client Sample ID: Lab Control Sample

Prep Type: Total/NA

Prep Batch: 82627

Analyte	Spike Added	LCS Result	LCS Qualifier	Unit	D	%Rec	%Rec. Limits
Acenaphthylene	1.67	1.465		mg/Kg		88	38 - 120
Anthracene	1.67	1.493		mg/Kg		90	46 - 124
Benzo[a]anthracene	1.67	1.429		mg/Kg		86	45 - 120
Benzo[a]pyrene	1.67	1.430		mg/Kg		86	45 - 120
Benzo[b]fluoranthene	1.67	1.496		mg/Kg		90	42 - 120
Benzo[g,h,i]perylene	1.67	1.501		mg/Kg		90	38 - 120
Benzo[k]fluoranthene	1.67	1.353		mg/Kg		81	42 - 120
1-Methylnaphthalene	1.67	1.385		mg/Kg		83	32 - 120
Pyrene	1.67	1.456		mg/Kg		87	43 - 120
Phenanthrene	1.67	1.470		mg/Kg		88	45 - 120
Chrysene	1.67	1.474		mg/Kg		88	43 - 120
Dibenz(a,h)anthracene	1.67	1.486		mg/Kg		89	32 - 128
Fluoranthene	1.67	1.464		mg/Kg		88	46 - 120
Fluorene	1.67	1.407		mg/Kg		84	42 - 120
Indeno[1,2,3-cd]pyrene	1.67	1.481		mg/Kg		89	41 - 121
Naphthalene	1.67	1.333		mg/Kg		80	32 - 120
2-Methylnaphthalene	1.67	1.344		mg/Kg		81	28 - 120

Surrogate	LCS %Recovery	LCS Qualifier	Limits
2-Fluorobiphenyl (Surr)	77		29 - 120
Terphenyl-d14 (Surr)	90		13 - 120
Nitrobenzene-d5 (Surr)	75		27 - 120

Lab Sample ID: 490-27175-C-1-B MS

Matrix: Solid

Analysis Batch: 83012

Client Sample ID: Matrix Spike

Prep Type: Total/NA

Prep Batch: 82627

Analyte	Sample Result	Sample Qualifier	Spike Added	MS Result	MS Qualifier	Unit	D	%Rec	%Rec. Limits
Acenaphthylene	ND		1.66	1.238		mg/Kg	☒	74	25 - 120
Anthracene	ND		1.66	1.389		mg/Kg	☒	84	28 - 125

TestAmerica Nashville



# QC Sample Results

Client: Small Business Group Inc.  
Project/Site: Laurel Bay Housing Project

TestAmerica Job ID: 490-27612-1

## Method: 8270D - Semivolatile Organic Compounds (GC/MS) (Continued)

Lab Sample ID: 490-27175-C-1-B MS

Matrix: Solid

Analysis Batch: 83012

Client Sample ID: Matrix Spike

Prep Type: Total/NA

Prep Batch: 82627

Analyte	Sample Result	Sample Qualifier	Spike Added	MS Result	MS Qualifier	Unit	D	%Rec	%Rec. Limits
Benzo[a]anthracene	ND		1.66	1.386		mg/Kg	✖	83	23 - 120
Benzo[a]pyrene	ND		1.66	1.350		mg/Kg	✖	81	15 - 128
Benzo[b]fluoranthene	ND		1.66	1.472		mg/Kg	✖	89	12 - 133
Benzo[g,h,i]perylene	ND		1.66	1.344		mg/Kg	✖	81	22 - 120
Benzo[k]fluoranthene	ND		1.66	1.252		mg/Kg	✖	75	28 - 120
1-Methylnaphthalene	ND		1.66	1.091		mg/Kg	✖	66	10 - 120
Pyrene	ND		1.66	1.385		mg/Kg	✖	83	20 - 123
Phenanthrene	ND		1.66	1.367		mg/Kg	✖	82	21 - 122
Chrysene	ND		1.66	1.378		mg/Kg	✖	83	20 - 120
Dibenz(a,h)anthracene	ND		1.66	1.392		mg/Kg	✖	84	12 - 128
Fluoranthene	ND		1.66	1.386		mg/Kg	✖	83	10 - 143
Fluorene	ND		1.66	1.290		mg/Kg	✖	78	20 - 120
Indeno[1,2,3-cd]pyrene	ND		1.66	1.374		mg/Kg	✖	83	22 - 121
Naphthalene	ND		1.66	1.027		mg/Kg	✖	62	10 - 120
2-Methylnaphthalene	ND		1.66	1.059		mg/Kg	✖	64	13 - 120

Surrogate	MS %Recovery	MS Qualifier	Limits
2-Fluorobiphenyl (Surr)	61		29 - 120
Terphenyl-d14 (Surr)	84		13 - 120
Nitrobenzene-d5 (Surr)	56		27 - 120

Lab Sample ID: 490-27175-C-1-C MSD

Matrix: Solid

Analysis Batch: 83012

Client Sample ID: Matrix Spike Duplicate

Prep Type: Total/NA

Prep Batch: 82627

Analyte	Sample Result	Sample Qualifier	Spike Added	MSD Result	MSD Qualifier	Unit	D	%Rec	%Rec. Limits	RPD	Limit
Acenaphthylene	ND		1.67	1.251		mg/Kg	✖	75	25 - 120	1	50
Anthracene	ND		1.67	1.358		mg/Kg	✖	81	28 - 125	2	49
Benzo[a]anthracene	ND		1.67	1.346		mg/Kg	✖	81	23 - 120	3	50
Benzo[a]pyrene	ND		1.67	1.316		mg/Kg	✖	79	15 - 128	3	50
Benzo[b]fluoranthene	ND		1.67	1.453		mg/Kg	✖	87	12 - 133	1	50
Benzo[g,h,i]perylene	ND		1.67	1.288		mg/Kg	✖	77	22 - 120	4	50
Benzo[k]fluoranthene	ND		1.67	1.211		mg/Kg	✖	73	28 - 120	3	45
1-Methylnaphthalene	ND		1.67	1.146		mg/Kg	✖	69	10 - 120	5	50
Pyrene	ND		1.67	1.379		mg/Kg	✖	83	20 - 123	0	50
Phenanthrene	ND		1.67	1.334		mg/Kg	✖	80	21 - 122	2	50
Chrysene	ND		1.67	1.311		mg/Kg	✖	79	20 - 120	5	49
Dibenz(a,h)anthracene	ND		1.67	1.324		mg/Kg	✖	79	12 - 128	5	50
Fluoranthene	ND		1.67	1.334		mg/Kg	✖	80	10 - 143	4	50
Fluorene	ND		1.67	1.269		mg/Kg	✖	76	20 - 120	2	50
Indeno[1,2,3-cd]pyrene	ND		1.67	1.299		mg/Kg	✖	78	22 - 121	6	50
Naphthalene	ND		1.67	1.065		mg/Kg	✖	64	10 - 120	4	50
2-Methylnaphthalene	ND		1.67	1.114		mg/Kg	✖	67	13 - 120	5	50

Surrogate	MSD %Recovery	MSD Qualifier	Limits
2-Fluorobiphenyl (Surr)	61		29 - 120
Terphenyl-d14 (Surr)	82		13 - 120

TestAmerica Nashville

## QC Sample Results

Client: Small Business Group Inc.  
Project/Site: Laurel Bay Housing Project

TestAmerica Job ID: 490-27612-1

### Method: 8270D - Semivolatile Organic Compounds (GC/MS) (Continued)

Lab Sample ID: 490-27175-C-1-C MSD

Matrix: Solid

Analysis Batch: 83012

Client Sample ID: Matrix Spike Duplicate

Prep Type: Total/NA

Prep Batch: 82627

Surrogate	MSD	MSD	Limits
	%Recovery	Qualifier	
Nitrobenzene-d5 (Surr)	57		27 - 120

### Method: Moisture - Percent Moisture

Lab Sample ID: 490-27616-E-1 DU

Matrix: Solid

Analysis Batch: 82546

Client Sample ID: Duplicate

Prep Type: Total/NA

Analyte	Sample	Sample	DU	DU	Unit	D	RPD	RPD	Limit
	Result	Qualifier	Result	Qualifier					
Percent Solids	72		78		%		8		20

TestAmerica Nashville

## QC Association Summary

Client: Small Business Group Inc.  
Project/Site: Laurel Bay Housing Project

TestAmerica Job ID: 490-27612-1

### GC/MS VOA

#### Prep Batch: 81976

Lab Sample ID	Client Sample ID	Prep Type	Matrix	Method	Prep Batch
490-27504-A-12-D MS	Matrix Spike	Total/NA	Solid	5035	
490-27504-A-12-E MSD	Matrix Spike Duplicate	Total/NA	Solid	5035	

#### Prep Batch: 82576

Lab Sample ID	Client Sample ID	Prep Type	Matrix	Method	Prep Batch
490-27612-5	265 Beech-2	Total/NA	Solid	5035	

#### Prep Batch: 82579

Lab Sample ID	Client Sample ID	Prep Type	Matrix	Method	Prep Batch
490-27612-1	610 Dahlia	Total/NA	Solid	5035	
490-27612-2	637 Dahlia-1	Total/NA	Solid	5035	
490-27612-3	637 Dahlia-2	Total/NA	Solid	5035	
490-27612-4	265 Beech-1	Total/NA	Solid	5035	
490-27612-5	265 Beech-2	Total/NA	Solid	5035	

#### Analysis Batch: 82946

Lab Sample ID	Client Sample ID	Prep Type	Matrix	Method	Prep Batch
490-27504-A-12-D MS	Matrix Spike	Total/NA	Solid	8260B	81976
490-27504-A-12-E MSD	Matrix Spike Duplicate	Total/NA	Solid	8260B	81976
490-27612-1	610 Dahlia	Total/NA	Solid	8260B	82579
490-27612-2	637 Dahlia-1	Total/NA	Solid	8260B	82579
490-27612-3	637 Dahlia-2	Total/NA	Solid	8260B	82579
490-27612-4	265 Beech-1	Total/NA	Solid	8260B	82579
490-27612-5	265 Beech-2	Total/NA	Solid	8260B	82579
LCS 490-82946/3	Lab Control Sample	Total/NA	Solid	8260B	
LCSD 490-82946/4	Lab Control Sample Dup	Total/NA	Solid	8260B	
MB 490-82946/6	Method Blank	Total/NA	Solid	8260B	

#### Analysis Batch: 83308

Lab Sample ID	Client Sample ID	Prep Type	Matrix	Method	Prep Batch
490-27612-5	265 Beech-2	Total/NA	Solid	8260B	82576
LCS 490-83308/3	Lab Control Sample	Total/NA	Solid	8260B	
LCSD 490-83308/4	Lab Control Sample Dup	Total/NA	Solid	8260B	
MB 490-83308/7	Method Blank	Total/NA	Solid	8260B	

### GC/MS Semi VOA

#### Prep Batch: 82627

Lab Sample ID	Client Sample ID	Prep Type	Matrix	Method	Prep Batch
490-27175-C-1-B MS	Matrix Spike	Total/NA	Solid	3550C	
490-27175-C-1-C MSD	Matrix Spike Duplicate	Total/NA	Solid	3550C	
490-27612-1	610 Dahlia	Total/NA	Solid	3550C	
490-27612-2	637 Dahlia-1	Total/NA	Solid	3550C	
490-27612-3	637 Dahlia-2	Total/NA	Solid	3550C	
490-27612-4	265 Beech-1	Total/NA	Solid	3550C	
490-27612-5	265 Beech-2	Total/NA	Solid	3550C	
LCS 490-82627/2-A	Lab Control Sample	Total/NA	Solid	3550C	
MB 490-82627/1-A	Method Blank	Total/NA	Solid	3550C	

TestAmerica Nashville



## QC Association Summary

Client: Small Business Group Inc.  
Project/Site: Laurel Bay Housing Project

TestAmerica Job ID: 490-27612-1

### GC/MS Semi VOA (Continued)

#### Analysis Batch: 83012

Lab Sample ID	Client Sample ID	Prep Type	Matrix	Method	Prep Batch
490-27175-C-1-B MS	Matrix Spike	Total/NA	Solid	8270D	82627
490-27175-C-1-C MSD	Matrix Spike Duplicate	Total/NA	Solid	8270D	82627
490-27612-1	610 Dahlia	Total/NA	Solid	8270D	82627
490-27612-2	637 Dahlia-1	Total/NA	Solid	8270D	82627
490-27612-3	637 Dahlia-2	Total/NA	Solid	8270D	82627
490-27612-4	265 Beech-1	Total/NA	Solid	8270D	82627
490-27612-5	265 Beech-2	Total/NA	Solid	8270D	82627
LCS 490-82627/2-A	Lab Control Sample	Total/NA	Solid	8270D	82627
MB 490-82627/1-A	Method Blank	Total/NA	Solid	8270D	82627

### General Chemistry

#### Analysis Batch: 82546

Lab Sample ID	Client Sample ID	Prep Type	Matrix	Method	Prep Batch
490-27612-1	610 Dahlia	Total/NA	Solid	Moisture	
490-27612-2	637 Dahlia-1	Total/NA	Solid	Moisture	
490-27612-3	637 Dahlia-2	Total/NA	Solid	Moisture	
490-27612-4	265 Beech-1	Total/NA	Solid	Moisture	
490-27612-5	265 Beech-2	Total/NA	Solid	Moisture	
490-27616-E-1 DU	Duplicate	Total/NA	Solid	Moisture	

# Lab Chronicle

Client: Small Business Group Inc.  
Project/Site: Laurel Bay Housing Project

TestAmerica Job ID: 490-27612-1

## Client Sample ID: 610 Dahlia

Date Collected: 05/20/13 15:15

Date Received: 05/29/13 08:00

## Lab Sample ID: 490-27612-1

Matrix: Solid

Percent Solids: 91.9

Prep Type	Batch Type	Batch Method	Run	Dilution Factor	Batch Number	Prepared or Analyzed	Analyst	Lab
Total/NA	Prep	5035			82579	05/29/13 15:28	ML	TAL NSH
Total/NA	Analysis	8260B		1	82946	05/31/13 15:28	AF	TAL NSH
Total/NA	Prep	3550C			82627	05/30/13 05:50	JP	TAL NSH
Total/NA	Analysis	8270D		1	83012	05/31/13 19:40	BS	TAL NSH
Total/NA	Analysis	Moisture		1	82546	05/29/13 14:20	RS	TAL NSH

## Client Sample ID: 637 Dahlia-1

Date Collected: 05/21/13 13:45

Date Received: 05/29/13 08:00

## Lab Sample ID: 490-27612-2

Matrix: Solid

Percent Solids: 77.2

Prep Type	Batch Type	Batch Method	Run	Dilution Factor	Batch Number	Prepared or Analyzed	Analyst	Lab
Total/NA	Prep	5035			82579	05/29/13 15:28	ML	TAL NSH
Total/NA	Analysis	8260B		1	82946	05/31/13 15:58	AF	TAL NSH
Total/NA	Prep	3550C			82627	05/30/13 05:50	JP	TAL NSH
Total/NA	Analysis	8270D		1	83012	05/31/13 20:01	BS	TAL NSH
Total/NA	Analysis	Moisture		1	82546	05/29/13 14:20	RS	TAL NSH

## Client Sample ID: 637 Dahlia-2

Date Collected: 05/21/13 15:15

Date Received: 05/29/13 08:00

## Lab Sample ID: 490-27612-3

Matrix: Solid

Percent Solids: 81.9

Prep Type	Batch Type	Batch Method	Run	Dilution Factor	Batch Number	Prepared or Analyzed	Analyst	Lab
Total/NA	Prep	5035			82579	05/29/13 15:28	ML	TAL NSH
Total/NA	Analysis	8260B		1	82946	05/31/13 16:29	AF	TAL NSH
Total/NA	Prep	3550C			82627	05/30/13 05:50	JP	TAL NSH
Total/NA	Analysis	8270D		1	83012	05/31/13 20:22	BS	TAL NSH
Total/NA	Analysis	Moisture		1	82546	05/29/13 14:20	RS	TAL NSH

## Client Sample ID: 265 Beech-1

Date Collected: 05/22/13 16:15

Date Received: 05/29/13 08:00

## Lab Sample ID: 490-27612-4

Matrix: Solid

Percent Solids: 77.3

Prep Type	Batch Type	Batch Method	Run	Dilution Factor	Batch Number	Prepared or Analyzed	Analyst	Lab
Total/NA	Prep	5035			82579	05/29/13 15:28	ML	TAL NSH
Total/NA	Analysis	8260B		1	82946	05/31/13 16:59	AF	TAL NSH
Total/NA	Prep	3550C			82627	05/30/13 05:50	JP	TAL NSH
Total/NA	Analysis	8270D		1	83012	05/31/13 20:43	BS	TAL NSH
Total/NA	Analysis	Moisture		1	82546	05/29/13 14:20	RS	TAL NSH

TestAmerica Nashville

## Lab Chronicle

Client: Small Business Group Inc.  
Project/Site: Laurel Bay Housing Project

TestAmerica Job ID: 490-27612-1

**Client Sample ID: 265 Beech-2**

**Lab Sample ID: 490-27612-5**

**Date Collected: 05/23/13 11:15**

**Matrix: Solid**

**Date Received: 05/29/13 08:00**

**Percent Solids: 76.7**

Prep Type	Batch Type	Batch Method	Run	Dilution Factor	Batch Number	Prepared or Analyzed	Analyst	Lab
Total/NA	Prep	5035			82579	05/29/13 15:28	ML	TAL NSH
Total/NA	Analysis	8260B		1	82946	05/31/13 17:29	AF	TAL NSH
Total/NA	Prep	5035			82576	05/29/13 15:26	ML	TAL NSH
Total/NA	Analysis	8260B		1	83308	06/02/13 04:28	AF	TAL NSH
Total/NA	Prep	3550C			82627	05/30/13 05:50	JP	TAL NSH
Total/NA	Analysis	8270D		1	83012	05/31/13 21:03	BS	TAL NSH
Total/NA	Analysis	Moisture		1	82546	05/29/13 14:20	RS	TAL NSH

### Laboratory References:

TAL NSH = TestAmerica Nashville, 2960 Foster Creighton Drive, Nashville, TN 37204, TEL (615)726-0177

## Method Summary

Client: Small Business Group Inc.  
Project/Site: Laurel Bay Housing Project

TestAmerica Job ID: 490-27612-1

Method	Method Description	Protocol	Laboratory
8260B	Volatile Organic Compounds (GC/MS)	SW846	TAL NSH
8270D	Semivolatile Organic Compounds (GC/MS)	SW846	TAL NSH
Moisture	Percent Moisture	EPA	TAL NSH

### Protocol References:

EPA = US Environmental Protection Agency

SW846 = "Test Methods For Evaluating Solid Waste, Physical/Chemical Methods", Third Edition, November 1986 And Its Updates.

### Laboratory References:

TAL NSH = TestAmerica Nashville, 2960 Foster Creighton Drive, Nashville, TN 37204, TEL (615)726-0177

## Certification Summary

Client: Small Business Group Inc.  
Project/Site: Laurel Bay Housing Project

TestAmerica Job ID: 490-27612-1

### Laboratory: TestAmerica Nashville

All certifications held by this laboratory are listed. Not all certifications are applicable to this report.

Authority	Program	EPA Region	Certification ID	Expiration Date
	ACIL		393	10-30-13
A2LA	ISO/IEC 17025		0453.07	12-31-13
Alaska (UST)	State Program	10	UST-087	07-24-13
Arizona	State Program	9	AZ0473	05-05-14 *
Arkansas DEQ	State Program	6	88-0737	04-25-14
California	NELAP	9	1168CA	10-31-13
Connecticut	State Program	1	PH-0220	12-31-13
Florida	NELAP	4	E87358	06-30-13
Illinois	NELAP	5	200010	12-09-13
Iowa	State Program	7	131	05-01-14
Kansas	NELAP	7	E-10229	10-31-13
Kentucky (UST)	State Program	4	19	09-15-13
Louisiana	NELAP	6	30613	06-30-13
Maryland	State Program	3	316	03-31-14
Massachusetts	State Program	1	M-TN032	06-30-13
Minnesota	NELAP	5	047-999-345	12-31-13
Mississippi	State Program	4	N/A	06-30-13
Montana (UST)	State Program	8	NA	01-01-15
Nevada	State Program	9	TN00032	07-31-13
New Hampshire	NELAP	1	2963	10-10-13
New Jersey	NELAP	2	TN965	06-30-13
New York	NELAP	2	11342	04-01-14
North Carolina DENR	State Program	4	387	12-31-13
North Dakota	State Program	8	R-146	06-30-13
Ohio VAP	State Program	5	CL0033	01-19-14
Oklahoma	State Program	6	9412	08-31-13
Oregon	NELAP	10	TN200001	04-29-14
Pennsylvania	NELAP	3	68-00585	06-30-13
Rhode Island	State Program	1	LAO00268	12-30-13
South Carolina	State Program	4	84009 (001)	05-31-14 *
South Carolina	State Program	4	84009 (002)	02-23-14
Tennessee	State Program	4	2008	02-23-14
Texas	NELAP	6	T104704077-09-TX	08-31-13
USDA	Federal		S-48469	11-02-13
Utah	NELAP	8	TAN	06-30-13
Virginia	NELAP	3	460152	06-14-13
Washington	State Program	10	C789	07-19-13
West Virginia DEP	State Program	3	219	02-28-14
Wisconsin	State Program	5	998020430	08-31-13
Wyoming (UST)	A2LA	8	453.07	12-31-13

\* Expired certification is currently pending renewal and is considered valid.

TestAmerica Nashville

## COOLER RECEIPT FORM



490-27612 Chain of Custody

Cooler Received/Opened On 5/29/2013 @ 0800

1. Tracking # 5592 (last 4 digits, FedEx)

Courier: Fedex IR Gun ID 17960358

2. Temperature of rep. sample or temp blank when opened: 1.9 Degrees Celsius

3. If Item #2 temperature is 0°C or less, was the representative sample or temp blank frozen? YES NO NA

4. Were custody seals on outside of cooler? YES...NO...NA

If yes, how many and where: 2 front + back

5. Were the seals intact, signed, and dated correctly? YES...NO...NA

6. Were custody papers inside cooler? YES...NO...NA

I certify that I opened the cooler and answered questions 1-6 (Initial) EA

7. Were custody seals on containers: YES NO and Intact YES...NO...NA

Were these signed and dated correctly? YES...NO...NA

8. Packing mat'l used? Bubblewrap Plastic bag Peanuts Vermiculite Foam Insert Paper Other None

9. Cooling process: Ice Ice-pack Ice (direct contact) Dry ice Other None

10. Did all containers arrive in good condition (unbroken)? YES...NO...NA

11. Were all container labels complete (#, date, signed, pres., etc)? YES...NO...NA

12. Did all container labels and tags agree with custody papers? YES...NO...NA

13a. Were VOA vials received? YES...NO...NA

b. Was there any observable headspace present in any VOA vial? YES NO...NA

14. Was there a Trip Blank in this cooler? YES...NO...NA If multiple coolers, sequence # NA

I certify that I unloaded the cooler and answered questions 7-14 (Initial) EA

15a. On pres'd bottles, did pH test strips suggest preservation reached the correct pH level? YES...NO...NA

b. Did the bottle labels indicate that the correct preservatives were used YES...NO...NA

16. Was residual chlorine present? YES...NO...NA

I certify that I checked for chlorine and pH as per SOP and answered questions 15-16 (Initial) EA

17. Were custody papers properly filled out (Ink, signed, etc)? YES...NO...NA

18. Did you sign the custody papers in the appropriate place? YES...NO...NA

19. Were correct containers used for the analysis requested? YES...NO...NA

20. Was sufficient amount of sample sent in each container? YES...NO...NA

I certify that I entered this project into LIMS and answered questions 17-20 (Initial) EA

I certify that I attached a label with the unique LIMS number to each container (Initial) EA

21. Were there Non-Conformance issues at login? YES...NO Was a NCM generated? YES...NO...#



# TestAmerica

THE LEADER IN ENVIRONMENTAL TESTING

Client Name/Account#: EEG - SBG # 2449

Address: 10179 Highway 78

City/State/Zip: Ladson, SC 29456

Project Manager: Tom McElwee email: mcelwee@eeginc.net

Telephone Number: 843.412.2092

Sample Name: (Print)

Sampler Signature:

Nashville Division  
2960 Foster Creighton  
Nashville, TN 37204

Phone: 615-726-0177  
Toll Free: 800-765-0980  
Fax: 615-726-3404

Site State: SC

PO#: 1035

TA Quote #:

Project ID: Laurel Bay Housing Project

Project #:

To assist us in using the proper analytical methods, is this work being conducted for regulatory purposes?

Compliance Monitoring?

Enforcement Action?

Yes No  
Yes No

Preservative

Matrix

Analyze For:

Loc: 490  
27612

RUSH TAT (Pre-Schedule)  
Standard TAT  
Fax Results

Sample ID / Description	Date Sampled	Time Sampled	No. of Containers Shipped	Grab	Composite	Field Filtered	Ice	HNO <sub>3</sub> (Red Label)	NH <sub>4</sub> OH (Orange Label)	H <sub>2</sub> SO <sub>4</sub> Plastic (Yellow Label)	H <sub>2</sub> SO <sub>4</sub> Glass (Yellow Label)	Nitro (Black Label)	Other (Specify)	Groundwater	Wastewater	Drinking Water	Sludge	Soil	Other (Specify)	BTEX + Naphth - 8260	PAH - 8270D	Analyze For:	Loc: 490 27612	RUSH TAT (Pre-Schedule)	Standard TAT	Fax Results
1010 Dahlia-1	5/20/13	1515	5	X																						
1037 Dahlia-1	5/21/13	1345	5	X																						
1037 Dahlia-2	5/21/13	1515	5	X																						
205 Beech-1	5/22/13	1615	5	X																						
205 Beech-2	5/23/13	1115	5	X																						

Special Instructions:

Method of Shipment:

FEDEX

Laboratory Comments:

Temperature Upon Receipt  
VOCs Free of Headspace?

Y N

Relinquished by:

Date

Time

Received by:

Date

Time

Relinquished by:

Date

Time

## Login Sample Receipt Checklist

Client: Small Business Group Inc.

Job Number: 490-27612-1

Login Number: 27612

List Source: TestAmerica Nashville

List Number: 1

Creator: Abernathy, Eric

Question	Answer	Comment
Radioactivity wasn't checked or is $\leq$ background as measured by a survey meter.	N/A	
The cooler's custody seal, if present, is intact.	True	
Sample custody seals, if present, are intact.	True	
The cooler or samples do not appear to have been compromised or tampered with.	True	
Samples were received on ice.	True	
Cooler Temperature is acceptable.	True	
Cooler Temperature is recorded.	True	
COC is present.	True	
COC is filled out in ink and legible.	True	
COC is filled out with all pertinent information.	True	
Is the Field Sampler's name present on COC?	True	
There are no discrepancies between the containers received and the COC.	True	
Samples are received within Holding Time.	True	
Sample containers have legible labels.	True	
Containers are not broken or leaking.	True	
Sample collection date/times are provided.	True	
Appropriate sample containers are used.	True	
Sample bottles are completely filled.	True	
Sample Preservation Verified.	N/A	
There is sufficient vol. for all requested analyses, incl. any requested MS/MSDs	True	
Containers requiring zero headspace have no headspace or bubble is $<6\text{mm}$ ( $1/4''$ ).	True	
Multiphasic samples are not present.	True	
Samples do not require splitting or compositing.	True	
Residual Chlorine Checked.	N/A	



**ATTACHMENT A**



# NON-HAZARDOUS MANIFEST

<b>NON-HAZARDOUS MANIFEST</b>		1. Generator's US EPA ID No.		Manifest Doc No.		2. Page 1 of 1	
3. Generator's Mailing Address: MCAS BEAUFORT LAUREL BAY HOUSING BEAUFORT, SC 29904		4. Generator's Phone 843-879-0411		Generator's Site Address (If different than mailing):		A. Manifest Number <b>WMNA</b> 01519142	
5. Transporter 1 Company Name <i>Carolina Containers</i> P.O. Box 1925 AF SC 29901		6. US EPA ID Number		C. State Transporter's ID		D. Transporter's Phone <i>(843) 521-1500</i>	
7. Transporter 2 Company Name		8. US EPA ID Number		E. State Transporter's ID		F. Transporter's Phone	
9. Designated Facility Name and Site Address HICKORY HILL LANDFILL 2621 LOW COUNTRY DRIVE RIDGELAND, SC 29936		10. US EPA ID Number		G. State Facility ID		H. State Facility Phone 843-987-4643	
11. Description of Waste Materials		12. Containers		13. Total Quantity	14. Unit Wt./Vol.	I. Misc. Comments	
		No.	Type				
		a. HEATING OIL TANK FILLED WITH SAND  WM Profile # 102655SC					
		b.  WM Profile #					
		c.  WM Profile #					
d.  WM Profile #							
J. Additional Descriptions for Materials Listed Above		K. Disposal Location		Cell		Level	
				Grid			
15. Special Handling Instructions and Additional Information <i>UST's from: 2) 610 Dahlia ✓ 4) 637 Dahlia - 2 ✓ 6) 297 Birch ✓</i> <i>1) 1403 Eagle ✓ 3) 637 Dahlia - 1 ✓ 5) 265 Beech - 3</i>							
Purchase Order #		EMERGENCY CONTACT / PHONE NO.:					
16. GENERATOR'S CERTIFICATE: I hereby certify that the above-described materials are not hazardous wastes as defined by 40 CFR Part 261 or any applicable state law, have been fully and accurately described, classified and packaged and are in proper condition for transportation according to applicable regulations.							
Printed Name <i>Timothy Whaley</i>		Signature "On behalf of" <i>Timothy Whaley</i>		Month 8		Day 14	
				Year 13			
17. Transporter 1 Acknowledgement of Receipt of Materials							
Printed Name <i>Reath Shaw</i>		Signature <i>Reath Shaw</i>		Month 8		Day 14	
				Year 13			
18. Transporter 2 Acknowledgement of Receipt of Materials							
Printed Name		Signature		Month		Day	
				Year			
19. Certificate of Final Treatment/Disposal I certify, on behalf of the above listed treatment facility, that to the best of my knowledge, the above-described waste was managed in compliance with all applicable laws, regulations, permits and licenses on the dates listed above.							
20. Facility Owner or Operator: Certification of receipt of non-hazardous materials covered by this manifest.							
Printed Name <i>Toni Colfield</i>		Signature <i>Toni Colfield</i>		Month 9		Day 3	
				Year 13			

White- TREATMENT, STORAGE, DISPOSAL FACILITY COPY

Pink- FACILITY USE ONLY

Blue- GENERATOR #2 COPY

Gold- TRANSPORTER #1 COPY

Yellow- GENERATOR #1 COPY

## **Appendix C**

### **Regulatory Correspondence**



Catherine E. Heigel, Director

*Promoting and protecting the health of the public and the environment*

July 1, 2015

Commanding Officer  
Attention: NREAO Mr. William A. Drawdy  
United State Marine Corps Air Station  
Post Office Box 55001  
Beaufort, SC 29904-5001

RE: No Further Action  
Laurel Bay Underground Storage Tank Assessment Reports for:  
*See attached sheet*

Dear Mr. Drawdy,

The South Carolina Department of Health and Environmental Control (the Department) received the referenced Underground Storage Tanks (USTs) Assessment Reports for the addresses listed above. The regulatory authority for the investigation and cleanup of releases from these tank systems is the South Carolina Pollution Control Act (S.C. Code Ann. §48-1-10 et seq., as amended).

The Department has reviewed the referenced assessment reports and agrees there is no indication of soil or groundwater contamination on these properties, and therefore no further investigation is required at this time.

Please note that the Department's decision is based on information provided by the Marine Corps Air Station (MCAS) to date. Any information found to be contradictory to this decision may require additional action. Furthermore, the Department retains the right to request further investigation if deemed necessary.

If you have any questions, please contact me at [kriegkm@dhec.sc.gov](mailto:kriegkm@dhec.sc.gov) or 803-898-0255.

Sincerely,

Kent Krieg  
Department of Defense Corrective Action Section  
Bureau of Land and Waste Management  
South Carolina Department of Health and Environmental Control

Cc: Russell Berry (via email)  
Craig Ehde (via email)  
Bryan Beck (via email)



Catherine E. Heigel, Director

*Promoting and protecting the health of the public and the environment*

**Attachment to:** Krieg to Drawdy  
**Subject:** NFA  
**Dated** 7/1/2015

**Laurel Bay Underground Storage Tank Assessment Reports for: (153 addresses/161 tanks)**

111 Birch	363 Aspen
123 Banyan	364 Aspen
131 Banyan	366 Aspen
134 Banyan	369 Aspen
145 Laurel Bay	373 Aspen
150 Laurel Bay	381 Aspen
153 Laurel Bay	401 Elderberry
154 Laurel Bay	402 Elderberry
155 Laurel Bay	404 Elderberry
200 Balsam	410 Elderberry
202 Balsam	420 Elderberry
203 Balsam	424 Elderberry
208 Balsam	435 Elderberry Tank 3
210 Balsam	452 Elderberry
211 Balsam	460 Elderberry
220 Cypress	465 Dogwood
222 Cypress	477 Laurel Bay
223 Cypress	487 Laurel Bay
252 Beech Tank 2	513 Laurel Bay
271 Beech Tank 1	519 Laurel Bay
271 Beech Tank 2	524 Laurel Bay
284 Birch Tank 1	535 Laurel Bay
284 Birch Tank 2	553 Dahlia
308 Ash	590 Aster
311 Ash	591 Aster
312 Ash	610 Dahlia
317 Ash	612 Dahlia
318 Ash	628 Dahlia
337 Ash	636 Dahlia
351 Ash Tank 1	637 Dahlia Tank 1
351 Ash Tank 2	637 Dahlia Tank 2
355 Ash Tank 1	641 Dahlia
355 Ash Tank 2	642 Dahlia Tank 1
360 Aspen	642 Dahlia Tank 2

**Laurel Bay Underground Storage Tank Assessment Reports for: (153 addresses/161 tanks) cont.**

655 Camellia	920 Albacore
662 Camellia	922 Barracuda Tank 1
683 Camellia	922 Barracuda Tank 2
684 Camellia	924 Albacore
689 Abelia	925 Albacore
694 Abelia	926 Albacore
695 Abelia	930 Albacore
741 Blue Bell	931 Albacore
742 Blue Bell	933 Albacore
755 Althea	936 Albacore
757 Althea	938 Albacore
776 Laurel Bay	939 Albacore
777 Azalea	940 Albacore
779 Laurel Bay	1010 Foxglove
781 Laurel Bay	1066 Gardenia
802 Azalea	1068 Gardenia
816 Azalea	1071 Heather Tank 2
822 Azalea	1100 Iris Tank 2
823 Azalea	1128 Iris
825 Azalea	1178 Bobwhite
828 Azalea	1204 Cardinal
837 Azalea	1208 Cardinal
851 Dolphin	1209 Cardinal
856 Dolphin	1210 Cardinal
857 Dolphin	1215 Cardinal
861 Dolphin	1216 Cardinal
864 Dolphin	1217 Cardinal Tank 1
868 Dolphin	1217 Cardinal Tank 2
872 Dolphin	1233 Dove
879 Cobia	1244 Dove
886 Cobia	1250 Dove
888 Cobia	1252 Dove
889 Cobia	1254 Dove
901 Barracuda	1256 Dove
902 Barracuda	1258 Dove
903 Barracuda	1263 Dove
904 Barracuda	1269 Dove
909 Barracuda	1276 Dove
910 Barracuda	1283 Dove
914 Barracuda	1285 Dove
915 Barracuda	1288 Eagle

**Laurel Bay Underground Storage Tank Assessment Reports for: (153 addresses/161 tanks) cont.**

1296 Eagle	1330 Albatross
1307 Eagle	1331 Albatross
1321 Albatross	1333 Albatross
1322 Albatross	1334 Albatross
1327 Albatross	1335 Albatross
1328 Albatross	